



Glencairn Road, SW16

£585,000

OFFERS OVER - A well-proportioned three-bedroom family home offering over 900 sq ft of bright, spacious living accommodation. The property features a separate kitchen and dining area, with three versatile bedrooms ideal for modern family living or home working. There is also further extension to extend subject to the relevant permissions.

Glencairn Road is ideally located just off Streatham High Road, with its wide selection of shops, bars and restaurants only moments away. Nearby stations at Norbury and Streatham Common provide frequent mainline services to London Victoria and London Bridge, offering excellent connections into Central London.

Features

- Three Bedrooms
- Convenient Location
- Terraced House
- Front Facing Reception
- Separate Kitchen/Dining Room
- Over 900 Sq Ft

Glencairn Road, London, SW16

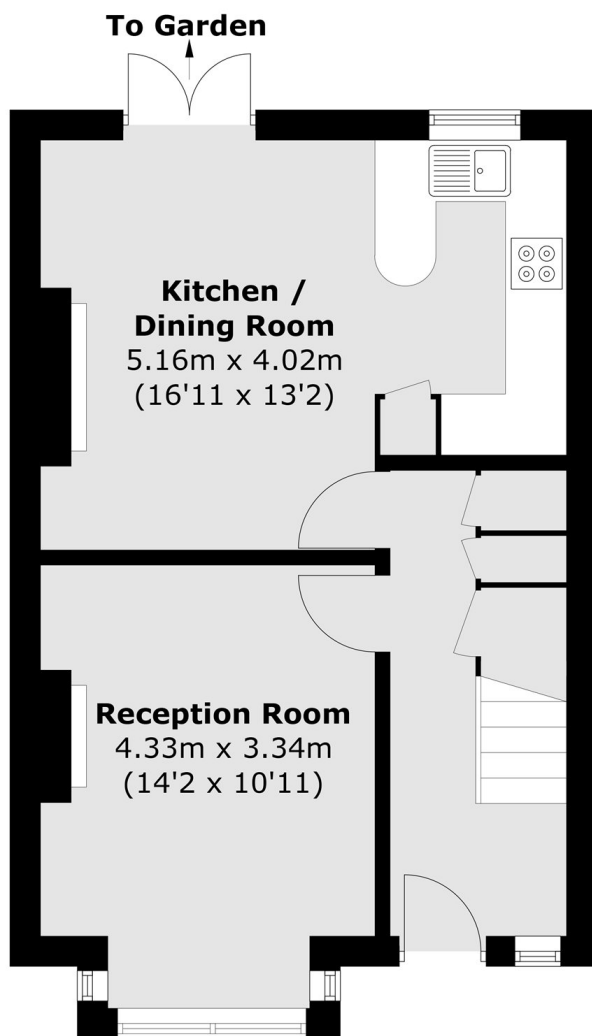

Ground Floor

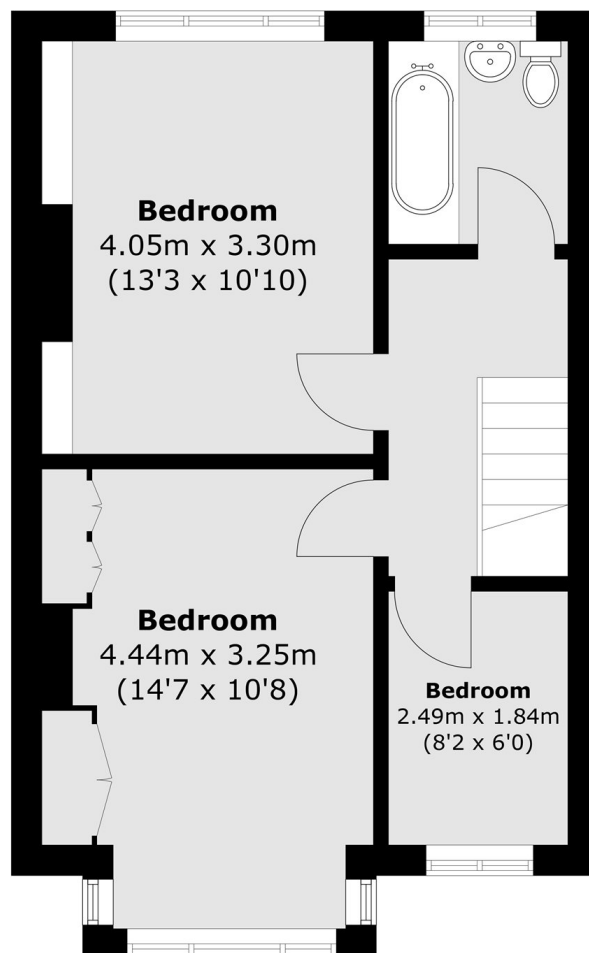

First Floor

Total area (approx.): 84.6 sq. m (910.5 sq. ft)