



## Buckleigh Road, SW16

### £280,000

Spread over part of the ground floor of this period property, is this bright one double bedroom home. The large front bedroom has high ceiling's and fitted shutters whilst the rear reception is quiet with a large window. There is also a modern separate kitchen and bathroom.

The property is located just off Greyhound lane which is equidistant to both Streatham Common and Streatham mainline stations. Streatham High Road is a short walk and offers a vast choice when it comes to cafes, restaurants, bars and the open spaces of Streatham Common

### Features

- One double bedroom
- Separate Kitchen
- Share of Freehold
- Bright Flat
- Fitted Shutters
- Close to Station

# Buckleigh Road, London, SW16

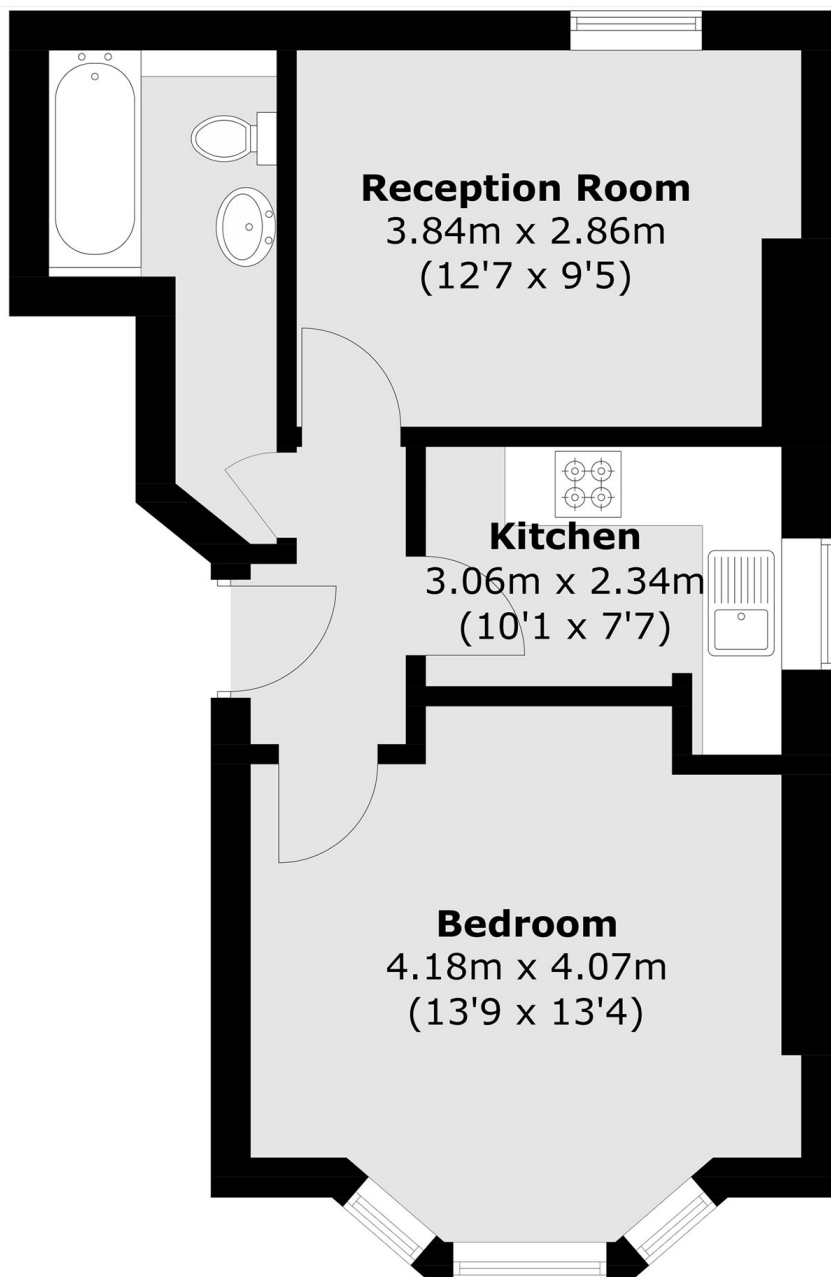

Total area (approx.): 39.3 sq. m (423.0 sq. ft)

## Dexters

Streatham  
105 Streatham Hill  
London  
SW2 4UG  
Sales  
020 8674 7400

Energy Rating: C. We aim to make our particulars both accurate and reliable. However they are not guaranteed; nor do they form part of an offer or contract. If you require clarification on any points then please contact us, especially if you're traveling some distance to view. Please note that appliances and heating systems have not been tested and therefore no warranties can be given as to their good working order.

 **RICS** | Regulated  
Estate Agent  
and Letting Agent

dexters.co.uk