



## Whitton Dene, TW7

£2,250 Per calendar month

This three bedroom semi-detached house in really good condition offers a large private garden, a well presented galley style kitchen, laminate wood flooring throughout and on street parking.

Whitton Dene is conveniently located for easy access to Hounslow, Whitton and Twickenham town centres, transport links and amenities.

### Features

- Three Bedrooms
- Two Reception Rooms
- Modern Kitchen
- New Bathroom
- Wood Laminate Flooring
- On Street Parking

# Whitton Dene, Isleworth, TW7

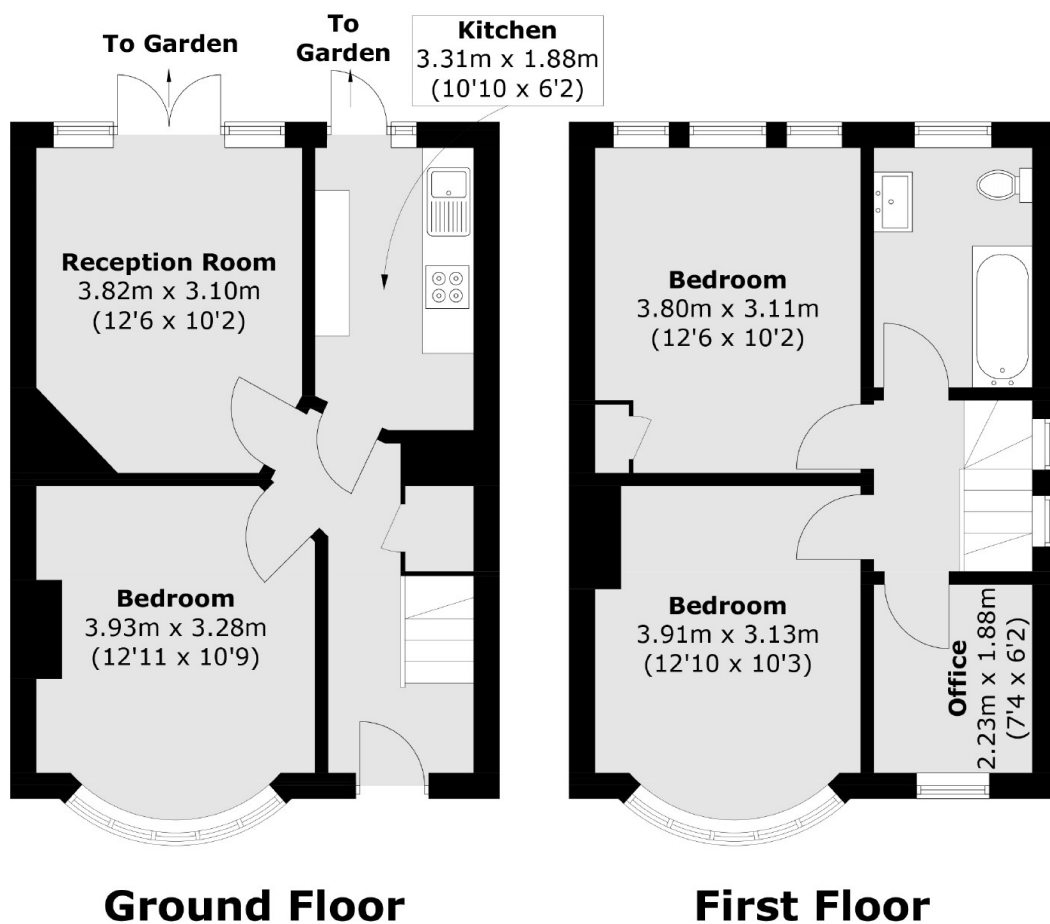

Total area (approx.): 76.8 sq. m (826.7 sq. ft)

## Dexters

Twickenham  
84 Heath Road  
Twickenham  
TW1 4BW  
Lettings  
020 8744 2233

Energy Rating: E. We aim to make our particulars both accurate and reliable. However they are not guaranteed; nor do they form part of an offer or contract. If you require clarification on any points then please contact us, especially if you're traveling some distance to view. Please note that appliances and heating systems have not been tested and therefore no warranties can be given as to their good working order.

 **RICS** | Regulated  
Estate Agent  
and Letting Agent

[dexters.co.uk](http://dexters.co.uk)