



Yeomans Mews, TW7

£499,950

Offered with no onward chain is this spacious three bedroom mid terrace mews style house that could be an ideal first home or investment. The house benefits from having downstairs W.C, a private garden with rear access and a garage in a block.

Yeomans Mews is conveniently located for easy access to Twickenham, Whitton and Isleworth Town Centres where you will find a vast array of shops, pubs and restaurants. There is also a fast train to London Waterloo from both Whitton & Twickenham mainline station.

Features

- Three Bedrooms
- No Onward Chain
- Rear Access
- Garage In A Block
- Downstairs W.C
- Overlooking Pretty Communal Lawn

Yeomans Mews, Whitton, TW7

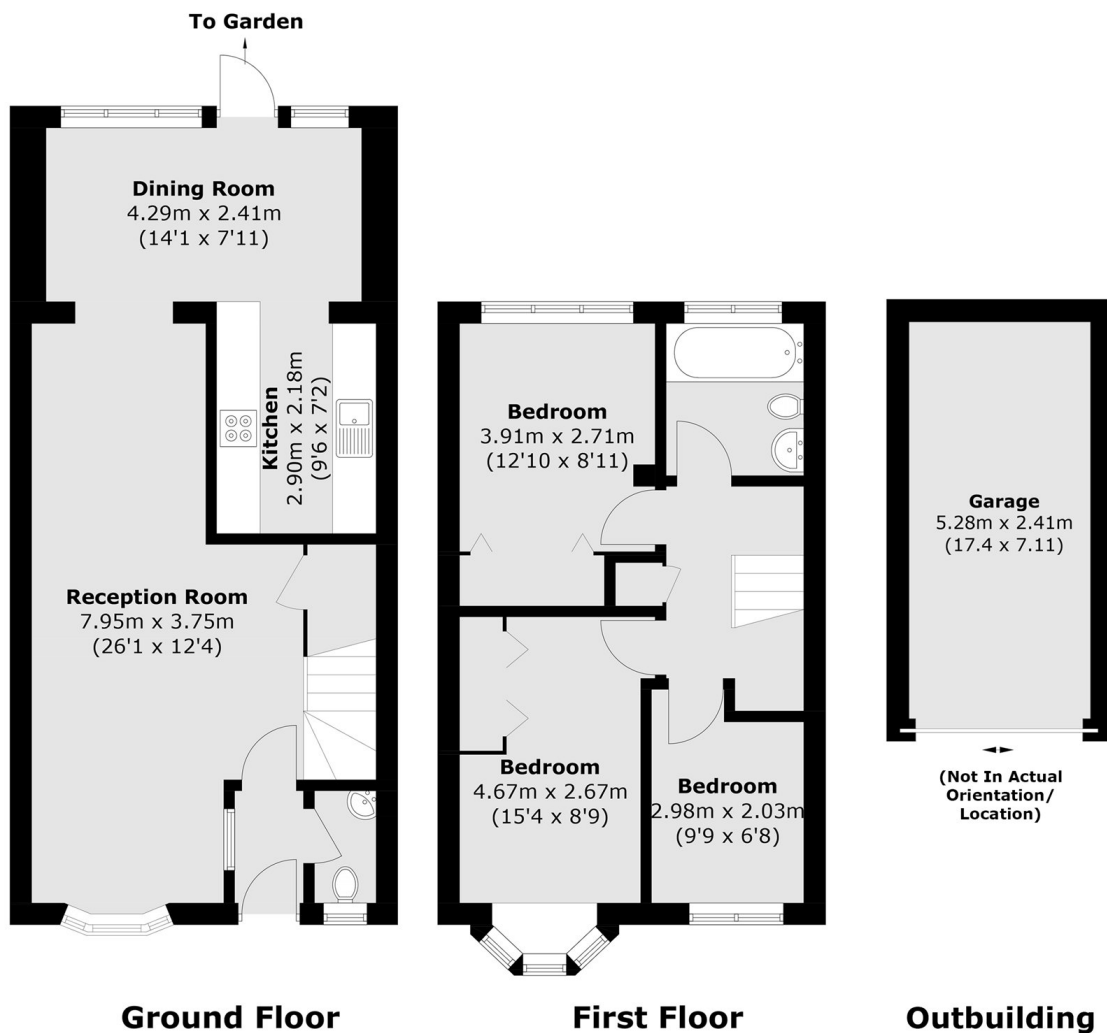

Total area (approx.): 89.0 sq. m (957.9 sq. ft)
Garage area (approx.): 12.7 sq. m (136.7 sq. ft)

Dexters

Twickenham
84 Heath Road
Twickenham
TW1 4BW
Sales
020 8744 0074

Energy Rating: E. We aim to make our particulars both accurate and reliable. However they are not guaranteed; nor do they form part of an offer or contract. If you require clarification on any points then please contact us, especially if you're traveling some distance to view. Please note that appliances and heating systems have not been tested and therefore no warranties can be given as to their good working order.

RICS | Regulated
Estate Agent
and Letting Agent

dexters.co.uk