



The Green, TW2

£340,000

This lovely modern one bedroom apartment offers great space and enviable views over Twickenham Green. Offered with no onward chain the apartment has its own entrance, communal gardens and an outside storage cupboard.

The Green is one of Twickenham's prime locations and is close to Twickenham town centre where you will find a vast array of shops and restaurants as well as the mainline station with it's fast link to Waterloo.

Features

- One Bedroom
- Top Floor Modern Apartment
- Communal Gardens
- Overlooking Twickenham Green
- Outside Storage Cupboard
- No Onward Chain

The Green, Twickenham, TW2

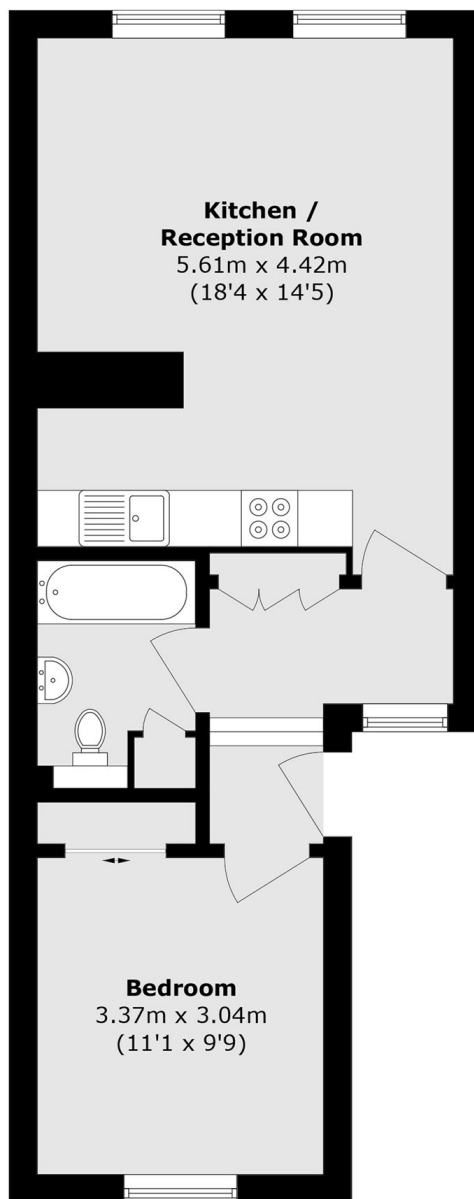

Total area (approx.): 46.5 sq. m (500.5 sq. ft)