

Heath Road, TW1

£1,500 Per calendar month

A well-presented and bright one-bedroom apartment ideally positioned on Heath Road in the heart of Twickenham. The accommodation comprises a separate kitchen and living room areas filled with natural light and a well-proportioned double bedroom.

Heath Road is the high street running through the heart of the town centre and it offers a vast array of shops, pubs, café's and restaurants. Twickenham mainline station provides a fast train to London Waterloo and there are also various bus routes in and out of Twickenham and through to Richmond.

Features

- One Double Bedroom
- Spacious Apartment
- Seperate Kitchen
- Central Location
- Plenty of Storage
- Close To The Station

Heath Road, Twickenham, TW1

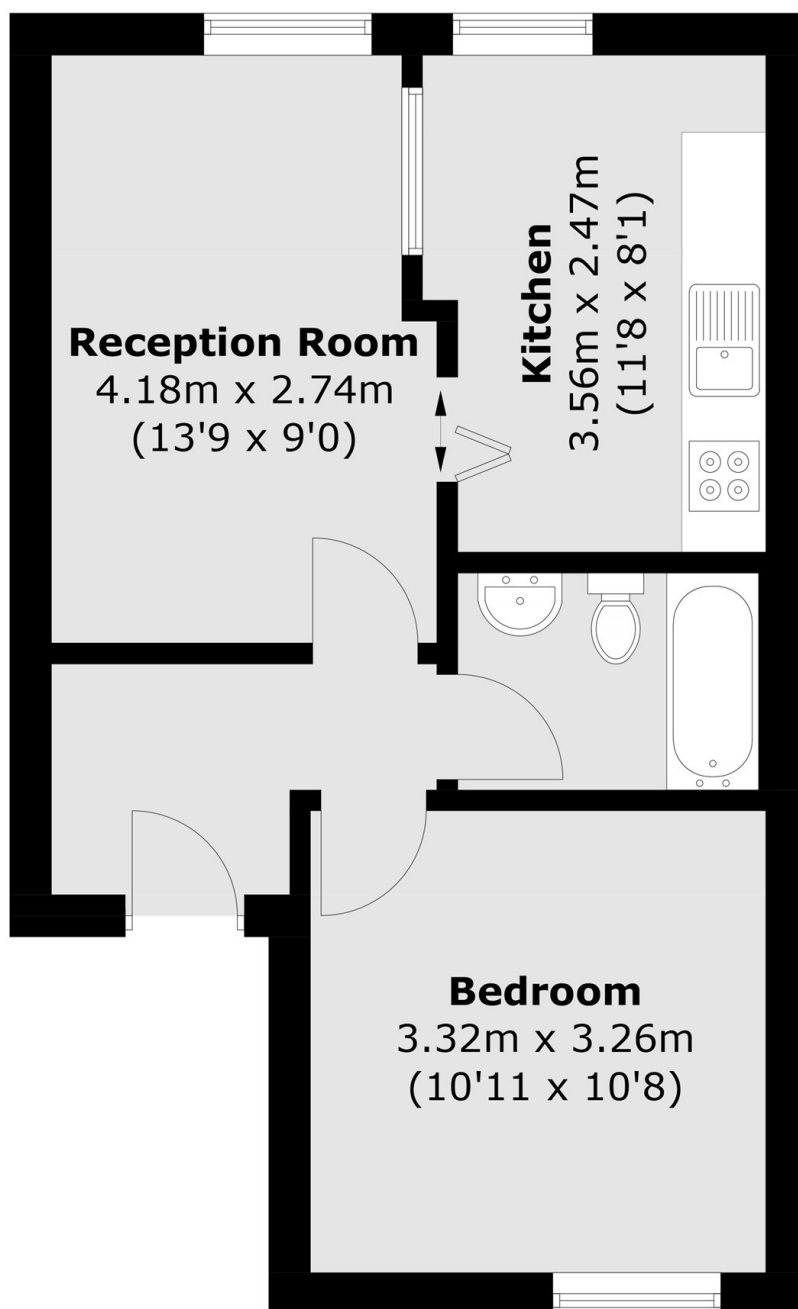

Total area (approx.): 39.5 sq. m (425.2 sq. ft)