



## Richmond Road, TW1

### £2,300 PCM

This beautifully presented two double bedroom apartment is located close to the River Thames and has a bright reception room, modern furnishings and the benefit of a large kitchen which is perfect for entertaining.

Lebanon Court is in a superb location with the River Thames, Twickenham town centre and its mainline station close by with its train links to the city.

### Features

- Two Double Bedrooms
- Fully Furnished
- Close To River Thames
- Eat-In Kitchen
- Built-In Storage
- Communal Gardens

# Richmond Road, Twickenham, TW1

## Fourth Floor

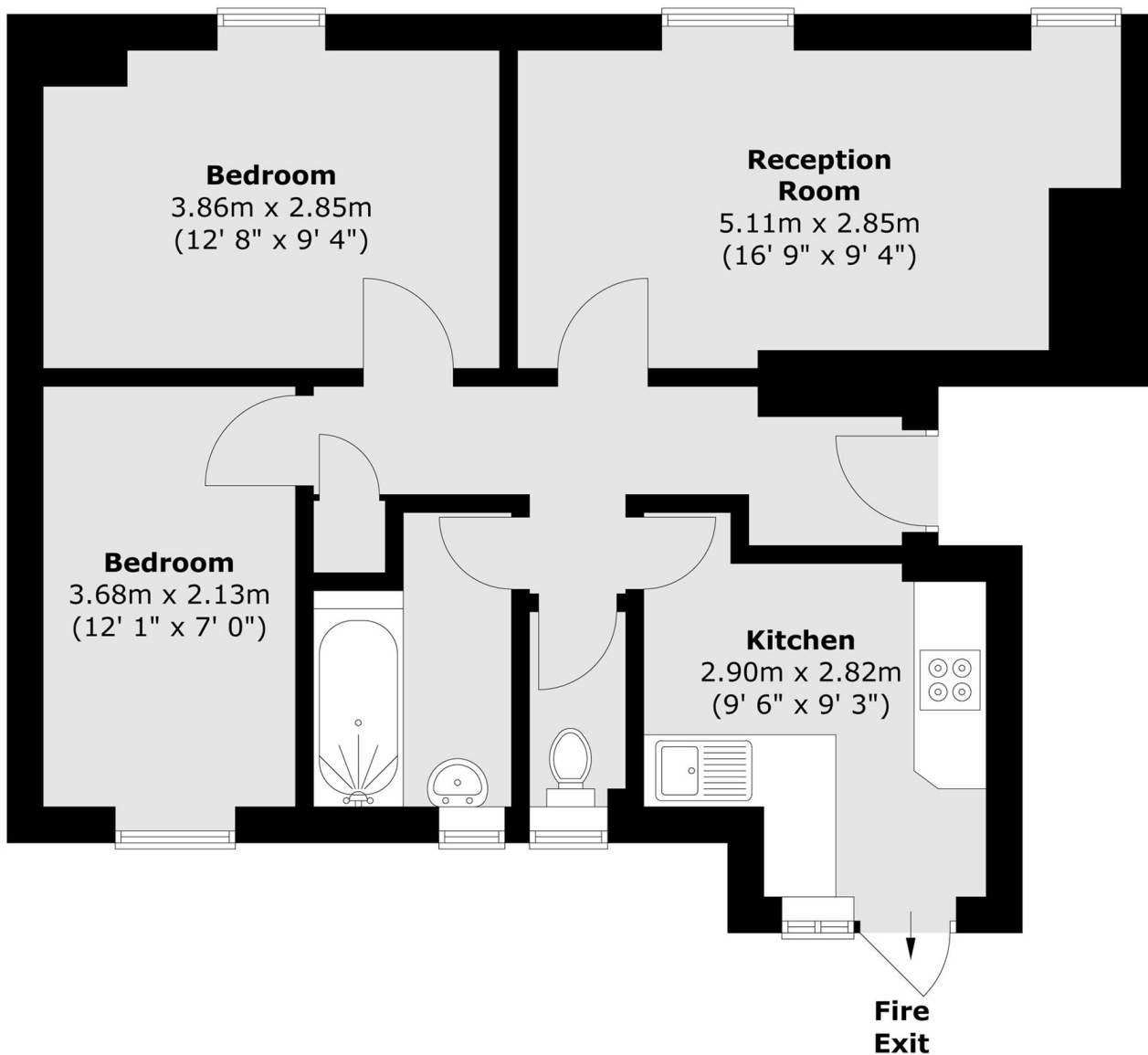

Total area (approx.) : 55.1 sq. m (593 sq. ft)