

## The Green, TW2

£1,800 Per calendar month

A beautifully presented two-bedroom apartment located right beside Twickenham Green. The property is bright and spacious throughout, the accommodation features an entrance hallway leading to a large reception room, which is semi-open plan to a modern kitchen with integrated appliances. The layout is completed by two well-proportioned bedrooms including a master with fitted wardrobes and a contemporary family bathroom.

The property is situated on Twickenham Green which is conveniently located for Twickenham High Street with its array of shops, cafes and restaurants. Twickenham and Strawberry Hill mainline stations (offering fast and direct services into London Waterloo) are close by, along with some outstanding local schools.

### Features

- Two Bedrooms
- Modern Kitchen & Bathroom
- Built in Storage
- Great Condition
- Excellent Location
- Close To Amenities

# The Green, Twickenham, TW2

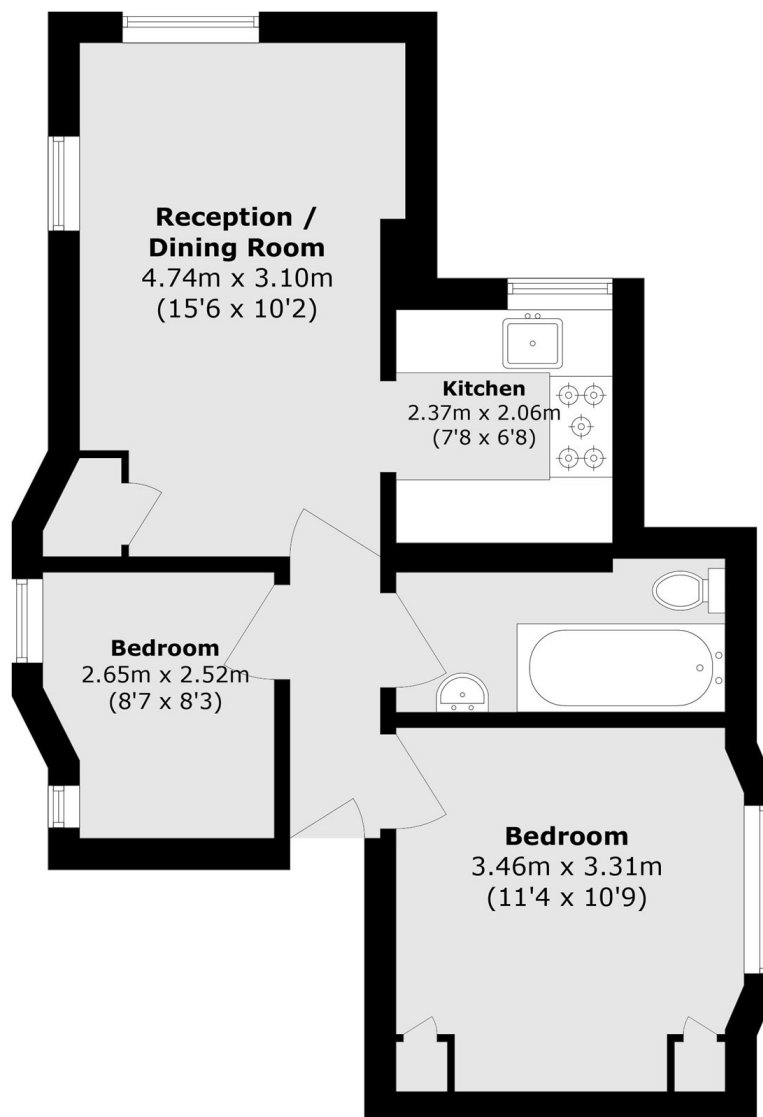

Total area (approx.): 44.9 sq. m (483.3 sq. ft)