



Norcutt Road, TW2

£595,000

Offered with no onward chain is this two bedroom Victorian cottage in excellent condition throughout. Perfectly located for commuters and professionals close to Twickenham Green.

Norcutt Road is a quiet cul-de-sac close to Twickenham town centre where you will find an array of shops, restaurants and pubs. Twickenham mainline station is half a mile away and has a fast link to Waterloo and there are many excellent schools nearby.

Features

- Two Double Bedrooms
- Victorian Cottage
- Twickenham Green Location
- Excellent Condition
- Courtyard Garden
- No Onward Chain

Norecutt Road, Twickenham, TW2

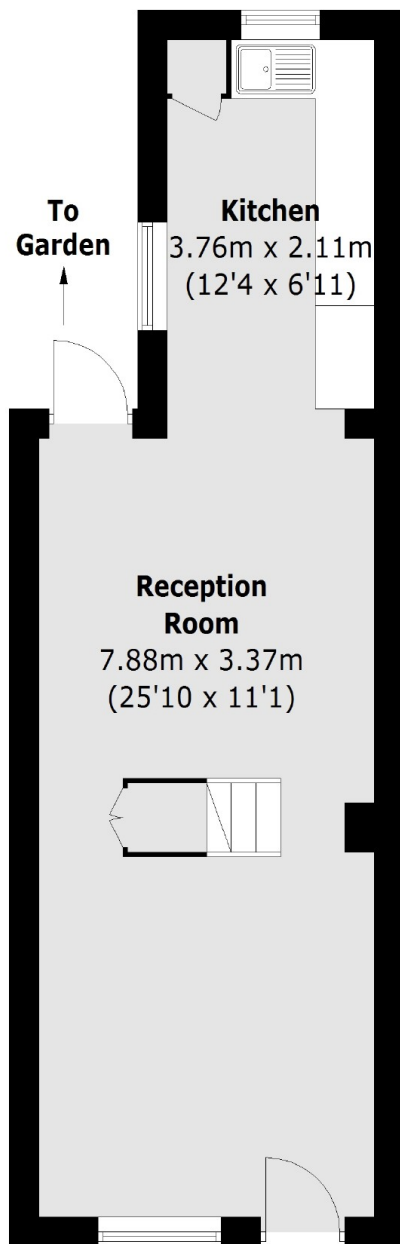

Ground Floor

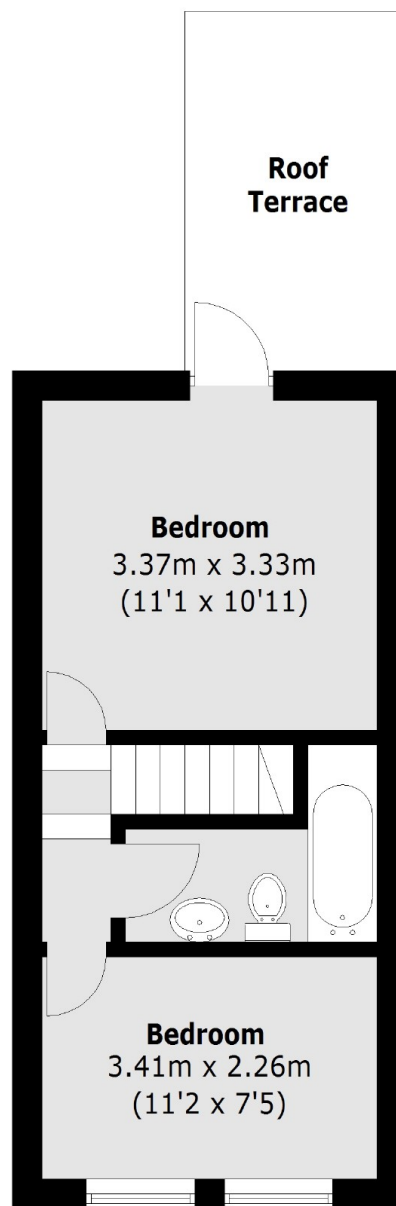

First Floor

Total area (approx.): 62.6 sq. m (673.8 sq. ft)
Roof Terrace: 8.2 sq. m (88.3 sq. ft)