



Selbourne Avenue, TW3

£400,000

A beautifully presented two double bedroom apartment offering over 900 square feet of modern living space in a highly sought-after contemporary development. This ground floor apartment features a generous open-plan kitchen and reception room with direct access to a private garden, perfect for entertaining. The property further benefits from two bathrooms, a long lease, and excellent transport links close by.

The property is a short walk from Hounslow East Underground Station, offering quick Piccadilly Line links to Central London and Heathrow Airport. It is also moments from Hounslow High Street, with its wide range of shops, cafés and restaurants, as well as nearby parks and green spaces.

Features

- Ground Floor Apartment
- Two Double Bedrooms
- Two Bathrooms
- Private Garden
- Long Lease
- Close to Amenities

Selbourne Avenue, Hounslow, TW3

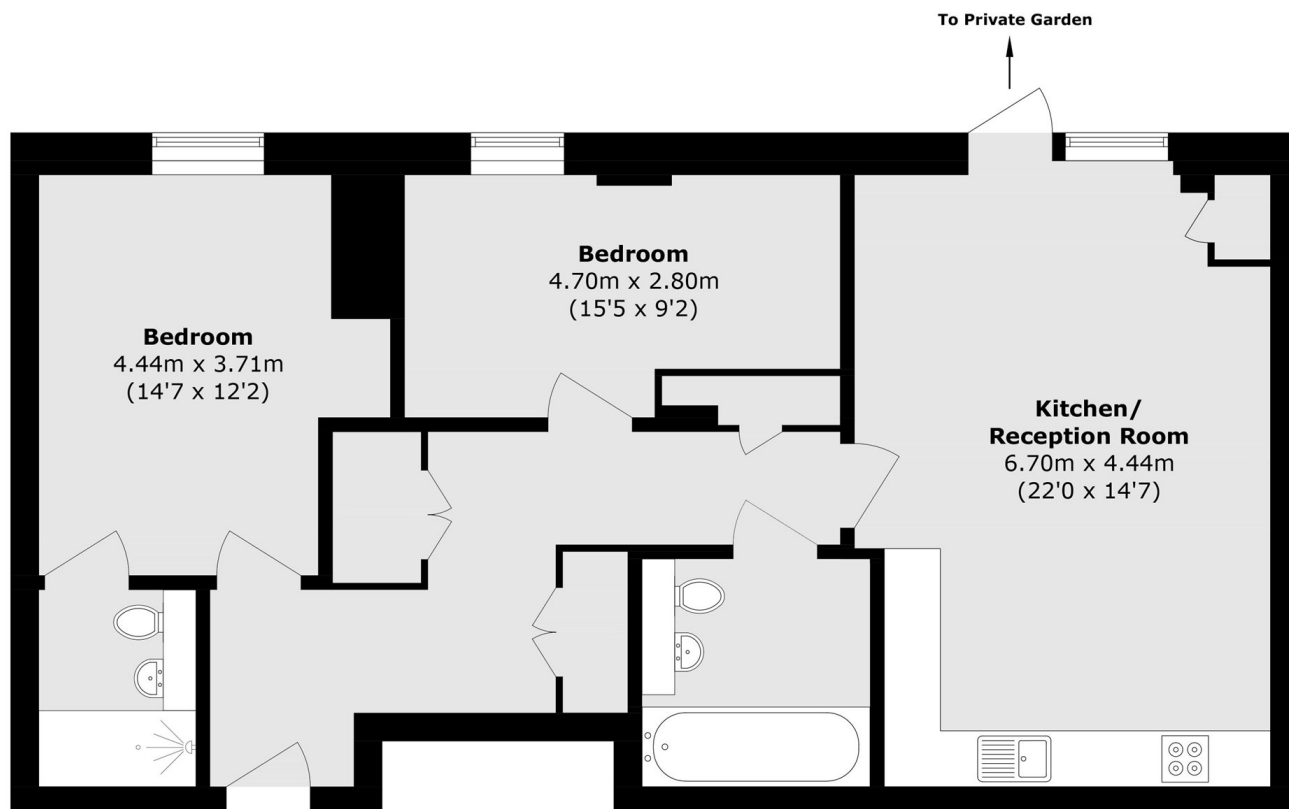

Total area (approx.): 85.8 sq. m (923.5 sq. ft)