



## Ellerdine Road, TW3

£2,700 Per calendar month

A stunning four-bedroom home arranged over three floors, offering three bathrooms, a separate W/C, modern living spaces, private garden with outbuilding, off-street parking, and a garage, ideal for a growing family.

Ellerdine Road is conveniently located close to Hounslow town centre, offering excellent transport links, local shops, schools, and green spaces, with easy access to central London and Heathrow Airport.

### Features

- Four Bedrooms
- Three Bathrooms
- Separate W/C
- Private Garden
- Off-Street Parking
- Garden Outbuilding





## Ellerdine Road, TW3

A welcoming ground floor presents elegant reception and dining areas, complemented by a contemporary kitchen opening onto the garden, plus a convenient separate W/C, delivering a sociable, practical space ideal for modern family life living.

Across three floors, four generously sized bedrooms and three bathrooms provide versatile accommodation, including an impressive upper-level suite, offering comfort for families, guests, or home-working professionals.

Outside, the property enjoys off-street parking, a private garage, and a well-maintained garden with an additional outbuilding, ideal for storage, a studio, or gym, enhancing lifestyle appeal and everyday convenience for modern households seeking space and flexibility.





# Ellerdine Road, Hounslow, TW3

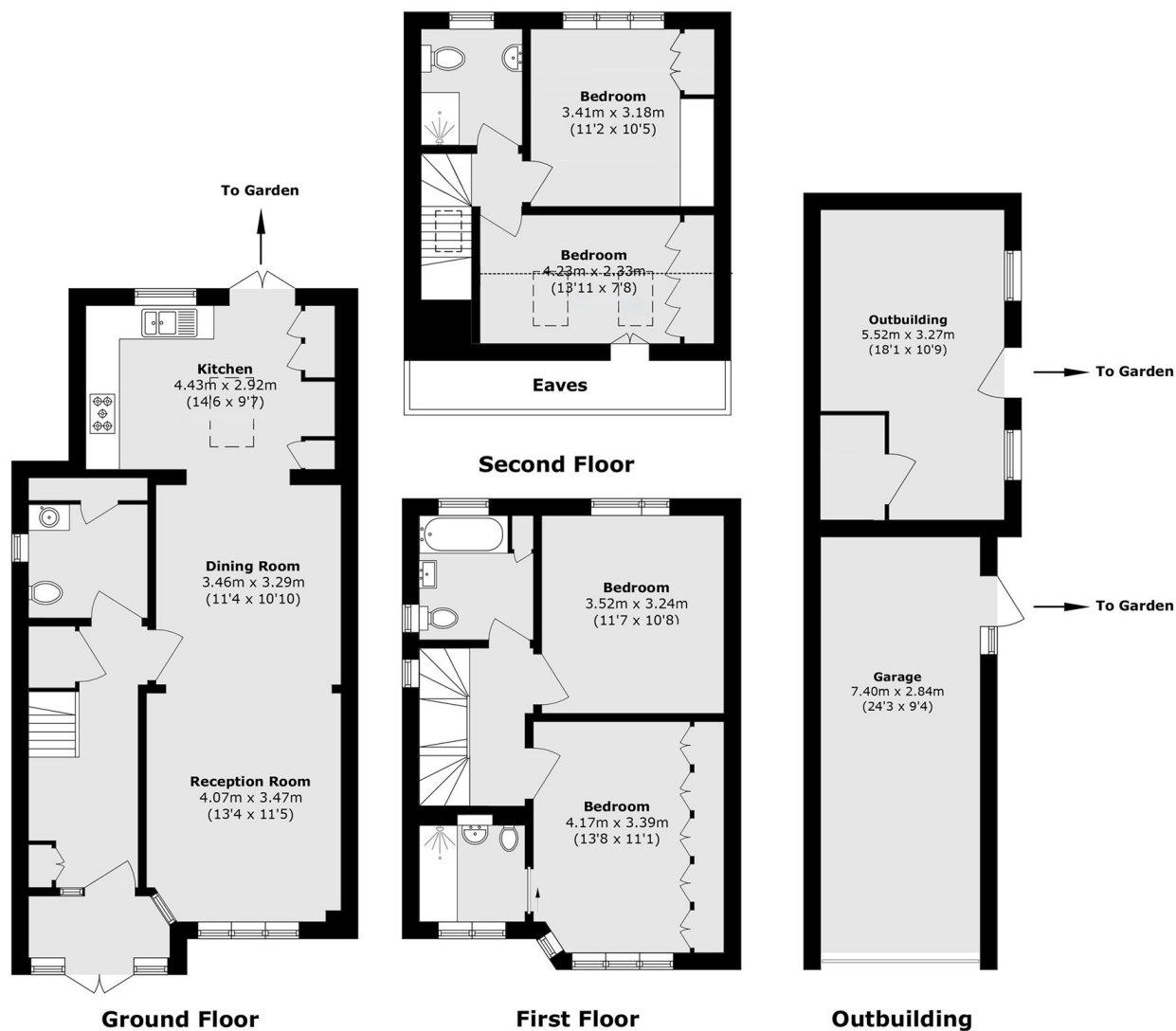

Total area (approx.): 129.5 sq. m (1393.9 sq. ft)  
(Excluding garage area & eaves)  
Outbuilding area (approx.): 18.1 sq. m (194.8 sq. ft)  
Garage area (approx.): 21.0 sq. m (226.0 sq. ft)

## Dexters

Isleworth  
568 London Road  
Isleworth  
TW7 4EP  
Lettings  
020 8560 1717

Energy Rating: . We aim to make our particulars both accurate and reliable. However they are not guaranteed; nor do they form part of an offer or contract. If you require clarification on any points then please contact us, especially if you're traveling some distance to view. Please note that appliances and heating systems have not been tested and therefore no warranties can be given as to their good working order.

**RICS** | Regulated  
Estate Agent  
and Letting Agent

dexters.co.uk