



Sidmouth Avenue, TW7

£290,000

A one bedroom first floor flat in exceptional condition, with secure gated, allocated parking. Additional benefits include long lease. Lift access and low annual service charges.

Situated on a quiet residential road, the property is within close proximity to Isleworth train station, local amenities and excellent schools. There are local parks nearby as well as easy access to the A4/M4 in and out of London.

Features

- Allocated Gated Parking
- Close to Shops
- Close to Station
- Fantastic Condition
- Long Lease

Sidmouth Avenue,
Isleworth, TW7

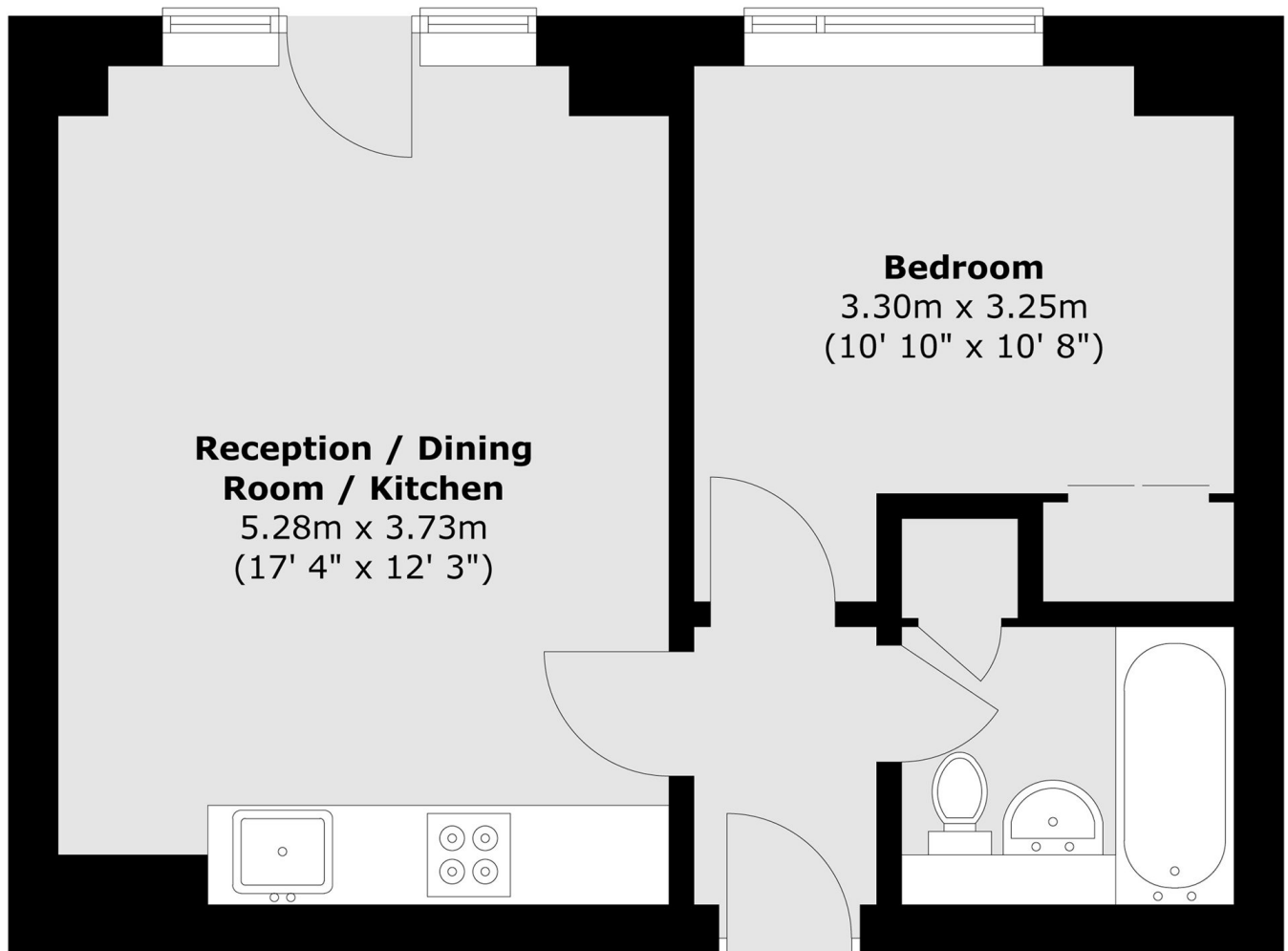

Total area (approx.) :36.6 sq. m (394 sq. ft)

Dexters

Isleworth
568 London Road
Isleworth
TW7 4EP
Sales
020 8560 1177

Energy Rating: . We aim to make our particulars both accurate and reliable. However they are not guaranteed; nor do they form part of an offer or contract. If you require clarification on any points then please contact us, especially if you're traveling some distance to view. Please note that appliances and heating systems have not been tested and therefore no warranties can be given as to their good working order.

 **RICS** | Regulated
Estate Agent
and Letting Agent

[dexters.co.uk](https://www.dexters.co.uk)