



Hanworth Road, TW3

£319,950

Situated on the top floor of this highly sought after and centrally located development, this exceptional two double bedroom penthouse apartment has been beautifully renovated to an outstanding standard throughout. The current owners have meticulously refurbished the property with no expense spared, creating a stylish and contemporary home. Highlights include a newly installed high specification kitchen and luxurious bathroom, a brand new heating system, and fresh, modern décor throughout. Further benefits include a long lease, lift access, allocated parking, and additional visitor parking making this an ideal home combining comfort, convenience, and quality.

Located in the heart of Hounslow close to shops and restaurants. Hounslow Central station (Piccadilly line) is also a short walk offering excellent links to Heathrow Airport and Central London. Hounslow Overground is also close by.

Features

- Penthouse Apartment
- Two Double Bedrooms
- Immaculately Refurbished
- Allocated Parking
- Long Lease - 970 years
- Lift Service

Hanworth Road, Hounslow, TW3

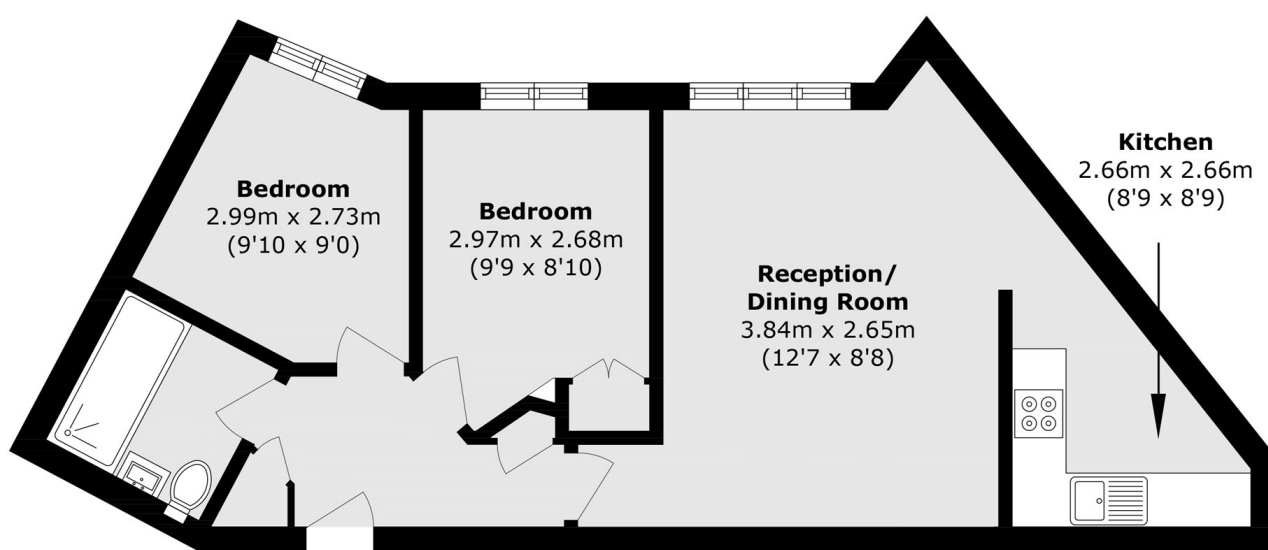

Total area (approx.): 52.4 sq. m (564.0 sq. ft)