



## Lynton Road, W3

£465,000

A newly converted one bedroom period conversion garden flat. This immaculate property offers in excess of 600 sq.ft of accommodation, comes with a large south facing garden, share of freehold and is offered with no onward chain.

Lynton Road is moments from the Elizabeth line station, Acton Main Line and within half a mile of the shops and amenities of Churchfield Road.

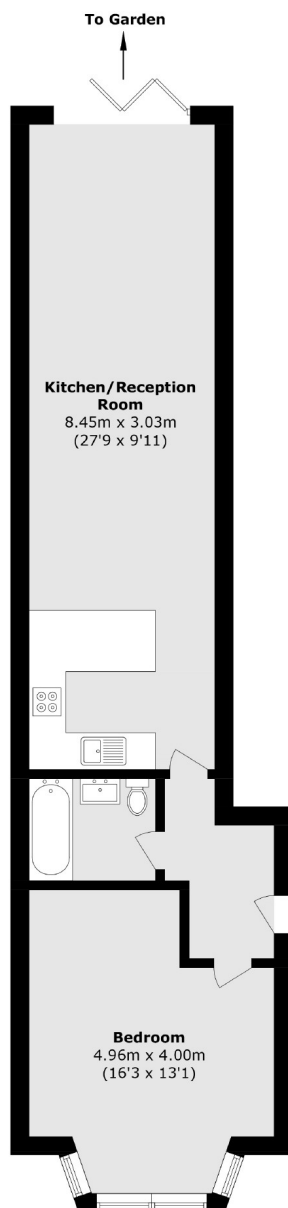

Total area (approx.): 57.1 sq. m (614.6 sq. ft)

Robertson Smith & Kempson Acton Sales  
137 High Street, Acton,  
London, W3 6LY  
020 8896 3996  
[actonsales@robertsonsmithandkempson.co.uk](mailto:actonsales@robertsonsmithandkempson.co.uk)

Energy Rating: C. We aim to make our particulars both accurate and reliable. However they are not guaranteed; nor do they form part of an offer or contract. If you require clarification on any points then please contact us, especially if you're traveling some distance to view. Please note that appliances and heating systems have not been tested and therefore no warranties can be given as to their good working order.