



Glebe Court, W5

£530 pw (£2,300 pcm)

This well-proportioned apartment, featuring two double bedrooms, is perfectly suited to a professional couple or sharers. The property features a large living space, a separate kitchen and access to a communal garden, along with a garage.

Glebe Court is ideally situated near Ealing Broadway's upmarket shops, dining options, and major transport links on the Central, District, Elizabeth and Overground lines.

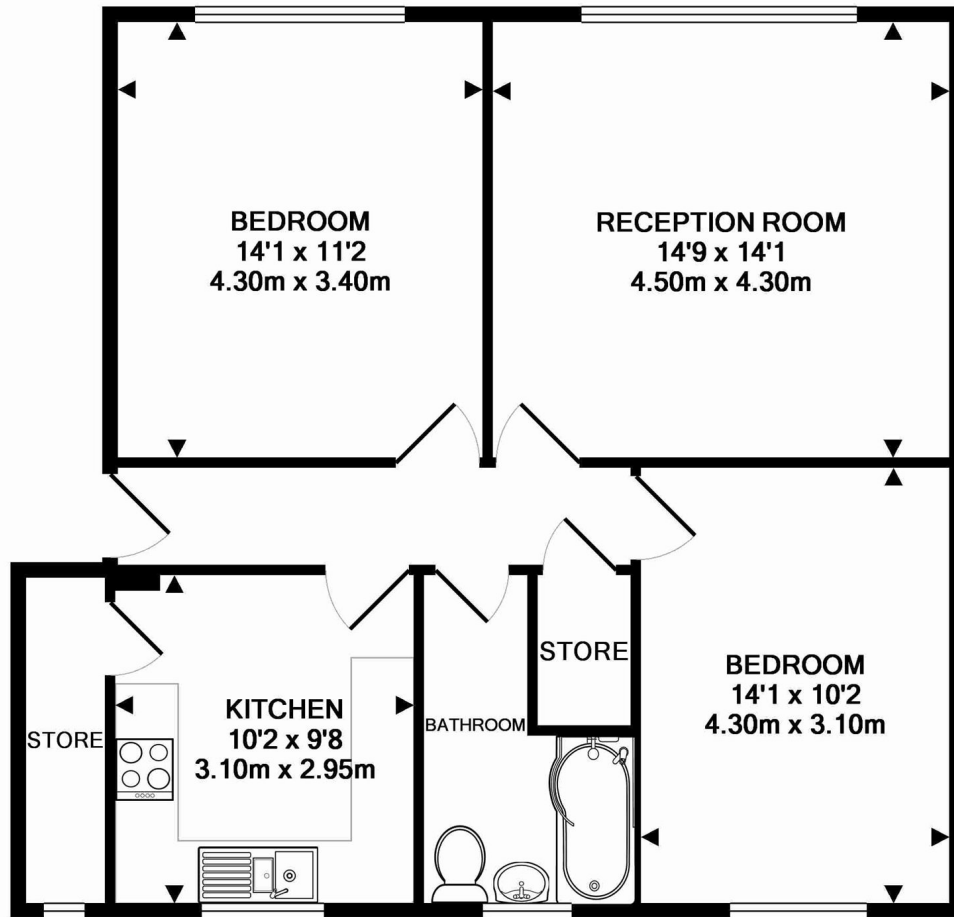

GLEBE COURT W5 5QW
TOTAL APPROX. FLOOR AREA 72.6 SQ.M. (782 SQ.FT.)

All measurements taken to RICS Guidelines for Gross Internal Area. Whilst every attempt has been made to ensure the accuracy of the floor plan contained here, all measurements are approximate and no responsibility is taken for any error, omission or misstatement. This plan is for illustrative purposes only and should be used as such by any prospective purchaser. The services, systems and appliances shown have not been tested and no guarantee as to their operability or efficiency can be given.

Made with Metropix ©2012

Robertson Smith & Kempson Ealing Lettings
1 The Broadway, London, W5
2NT
020 8840 7885
ealinglettings@robertsonsmithandkempson.co.uk

Energy Rating: D. We aim to make our particulars both accurate and reliable. However they are not guaranteed; nor do they form part of an offer or contract. If you require clarification on any points then please contact us, especially if you're traveling some distance to view. Please note that appliances and heating systems have not been tested and therefore no warranties can be given as to their good working order.