



## **Vicars Bridge Close, HA0**

**£369 pw (£1,600 pcm)**

This stylish one bedroom ground floor flat has been recently redecorated and offers a cosy and inviting living space. This property features spacious reception area, separate kitchen and a family bathroom. Additional benefits include off-street parking and perfectly situated in a desirable location.

Vicars Bridge Close is just over half a mile from Hanger Lane Tube Station and close to various shops and amenities.

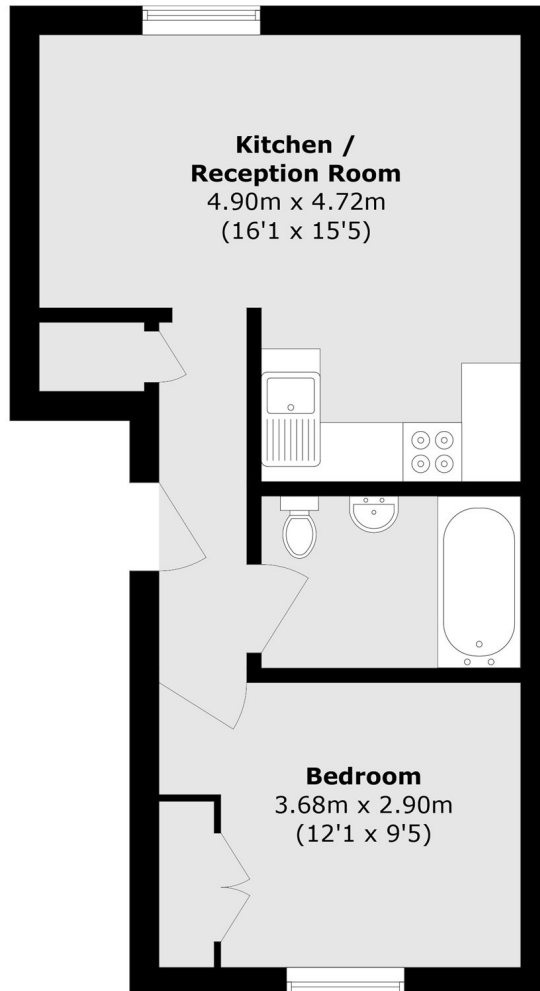

Total area (approx.): 39.4 sq. m (424.1 sq. ft)

Robertson Smith & Kempson Ealing Lettings  
1 The Broadway,  
London, W5 2NT  
020 8840 7885  
[ealinglettings@robertsonsmithandkempson.co.uk](mailto:ealinglettings@robertsonsmithandkempson.co.uk)

Energy Rating: D. We aim to make our particulars both accurate and reliable. However they are not guaranteed; nor do they form part of an offer or contract. If you require clarification on any points then please contact us, especially if you're traveling some distance to view. Please note that appliances and heating systems have not been tested and therefore no warranties can be given as to their good working order.