



## **Beechwood Avenue, UB6**

**£325,000**

This two bedroom ground floor maisonette has an enviable location on a residential street close to Ravenor Park. The property has a separate kitchen, private rear garden with a south easterly aspect and is offered to market with no chain.

Located on a quiet close within walking distance of Ravenor Park and a range of bus routes. Greenford station (Central line) is just over a mile away.

- No Onward Chain • Maisonette Style • Two Bedrooms •
- Own Entrance • Ground Floor • Double Glazed Windows •

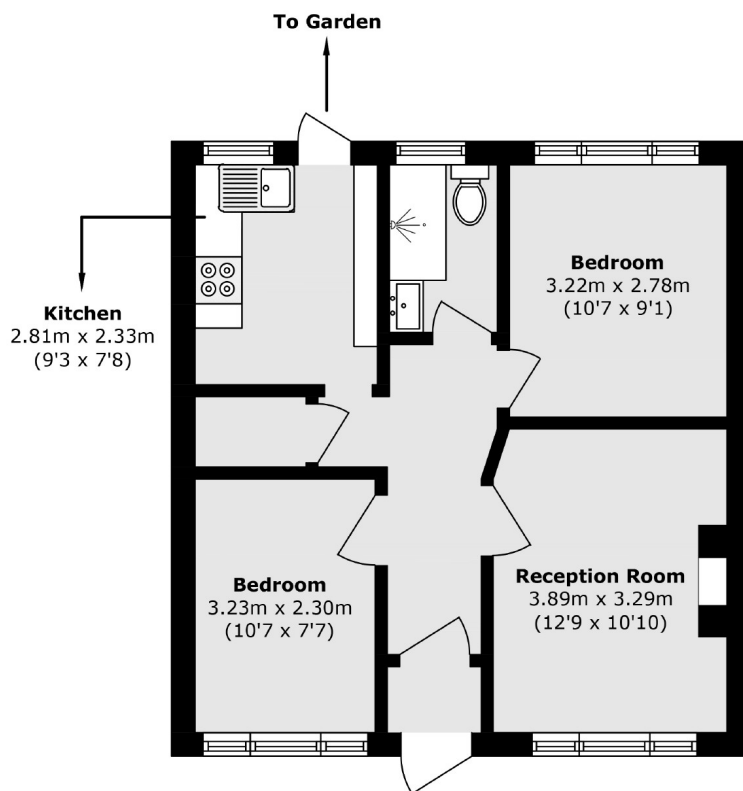

Total area (approx.): 49.1 sq. m (528.5 sq. ft)

Robertson Smith & Kempson Hanwell Sales  
69 Greenford Avenue,  
London, W7 1LL  
020 8566 2339  
[hanwellsales@robertsonsmithandkempson.co.uk](mailto:hanwellsales@robertsonsmithandkempson.co.uk)

Energy Rating: D. We aim to make our particulars both accurate and reliable. However they are not guaranteed; nor do they form part of an offer or contract. If you require clarification on any points then please contact us, especially if you're traveling some distance to view. Please note that appliances and heating systems have not been tested and therefore no warranties can be given as to their good working order.