



## Pound Lane, NW10

### £395,000

Welcome to Mosaic- a boutique collection of just nine beautifully crafted apartments, tucked away in a quiet residential pocket near the green open spaces of Roundwood Park. This bright and modern 1-bedroom home offers 586 sq ft of stylish, energy-efficient living. The spacious open-plan kitchen/living area opens directly onto a private garden perfect for relaxing, entertaining, or working from home outdoors.

Please note: photos shown are from a selection of apartments within the Mosaic development and may not represent the exact unit listed.

Located within walking distance of Dollis Hill Station (Jubilee Line), you can reach: Wembley Park in 4 mins and Bond Street & West End in 15 mins. Enjoy easy access to Roundwood Park and Gladstone Park, both offering tennis courts, gardens, walking trails, and ponds ideal for weekend relaxation. Early viewing is highly recommended contact us

### Features

- Private Garden
- High Specification
- Ready To Move In
- New Build Warranty
- Close To Dollis Hill Station

**Pound Lane,  
LONDON, NW10**

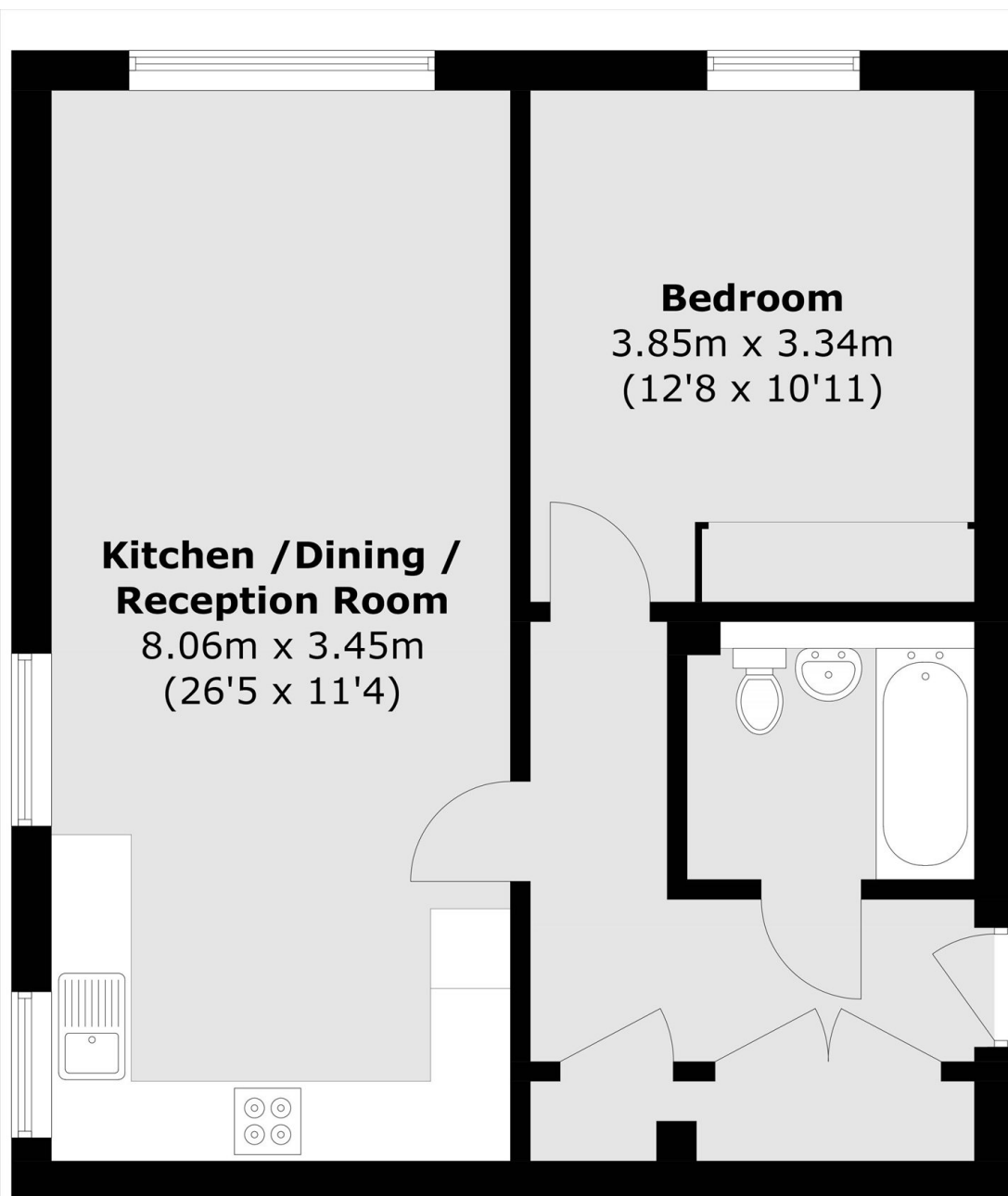

**Ground Floor**

Total area (approx.): 56.4 sq. m (607.1 sq. ft)