



WETHERELL
MAYFAIR'S FINEST PROPERTIES



HERTFORD STREET, W1J

£1,300,000

A smart 1 bedroom apartment situated within a popular Art Deco building with porter and lift.

Located on the third floor, this lateral apartment of 609 sq. Ft features a spacious a reception/dining room of 19ft, benefiting from 2 large windows allowing for plenty of natural light and a separate kitchen with breakfast bar. The apartment further comprises a double bedroom with ornamental balcony and en suite shower room. There is an additional guest WC.

Tenure - Leasehold, approximately 141 years remaining

Ground Rent: TBC

Service Charge: TBC

CARRINGTON HOUSE IS LOCATED IN THE SHEPHERDS MARKET AREA OF MAYFAIR, AN HISTORIC SQUARE AND PIAZZA WITH BOUTIQUE SHOPS AND RESTAURANTS. LOCAL TRANSPORT LINKS INCLUDE GREEN PARK TUBE STATION (0.3 MILES)



FEATURES

- One bedroom • Lateral • 609 sq. ft • Porter • Lift •



HERTFORD STREET,
LONDON, W1J

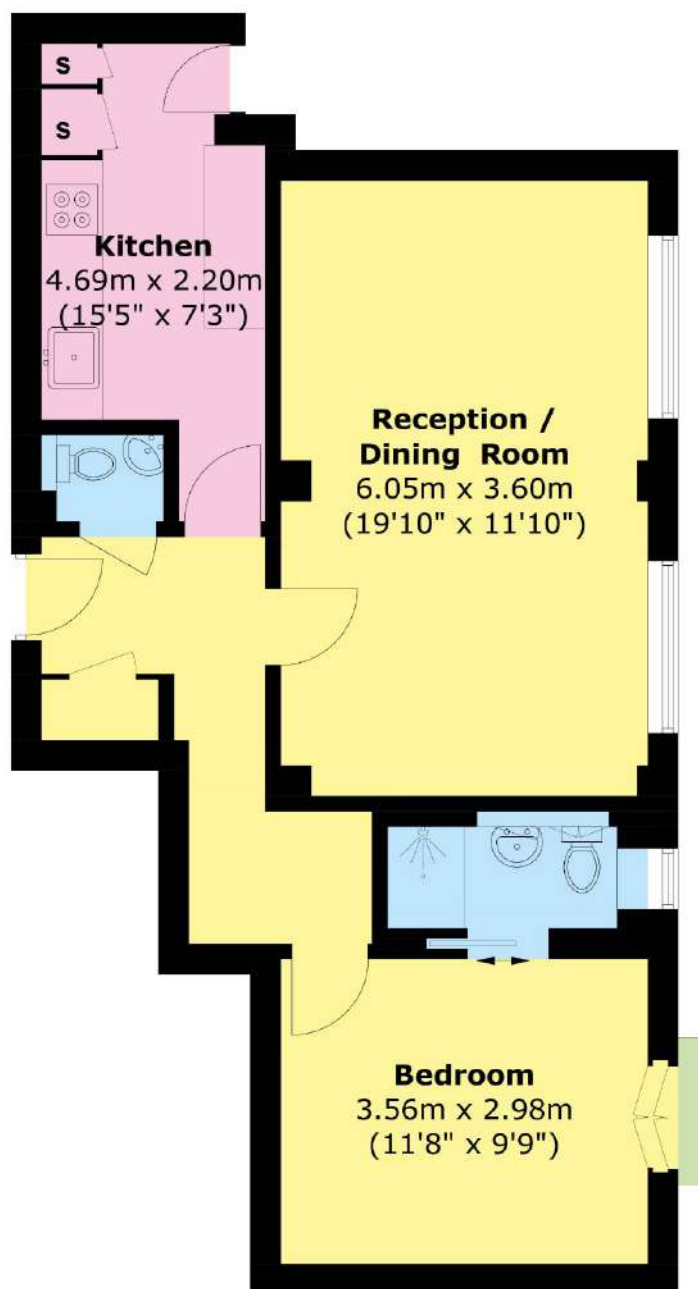

Third Floor

Area (approx.): 56.6 sq. m (609.0 sq. ft)



WETHERELL
MAYFAIR'S FINEST PROPERTIES

102 Mount Street,
London, W1K 2TH
T: 020 7529 5566
E: sales@wetherell.co.uk

We aim to make our particulars both accurate and reliable. However they are not guaranteed; nor do they form part of an offer or contract. If you require clarification on any points then please contact us, especially if you're traveling some distance to view. Please note that appliances and heating systems have not been tested and therefore no warranties can be given as to their working order.

wetherell.co.uk