



WETHERELL
MAYFAIR'S FINEST PROPERTIES



SOUTH AUDLEY STREET, W1K

£1,300 PER WEEK

A spacious double bedroom apartment situated on the ground floor of a popular portered building in the heart of Mayfair.

This stylish apartment has been meticulously refurbished throughout to provide a modern and contemporary living space within a classic portered Mayfair building within a classic ported Mayfair Building.

Recently refurbished with an open reception, two spacious bedrooms, two bathrooms and a modernised kitchen.

CHESTERFIELD GARDENS IS SITUATED JUST OFF CURZON STREET. THIS APARTMENT IS ONLY TWO STREETS AWAY FROM THE GREEN SPACES OF HYDE PARK AND THE WORLD RENOWNED DORCHESTER HOTEL.



FEATURES

- Two Double Bedrooms • Two Bathrooms • Open Reception Room • 24 Hour Porter • Newly Refurbished • Lift •



SOUTH AUDLEY STREET, LONDON, W1K

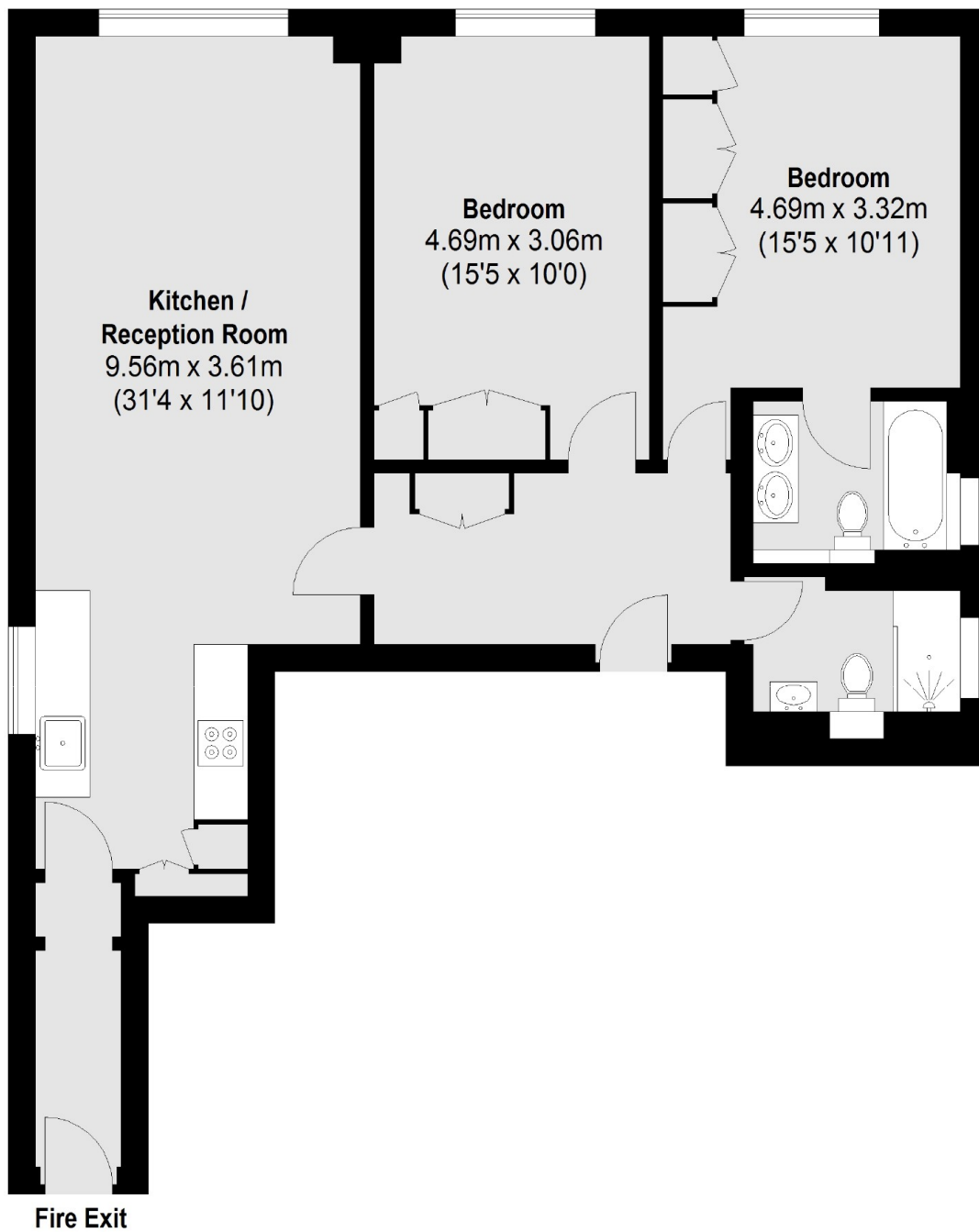

Ground Floor

Total area (approx.): 81.37 sq. m (876 sq. ft)