

Marchmont Street, WC1N

£525,000

A stylish, bright two double bedroom flat on the second floor of this well-maintained period conversion with a gated entrance. This high ceiling apartment benefits from an over 100 year lease, no onward chain and low service charges.

Located near the junction of Tavistock Place, Marchmont Street is just a few yards from the Brunswick Centre, Russell Square and St Pancras International stations.

Features

- Gated Entrance
- Two Bedroom
- No Onward Chain
- High Ceilings
- Period features
- Low Service Charge

Marchmont Street, London, WC1N

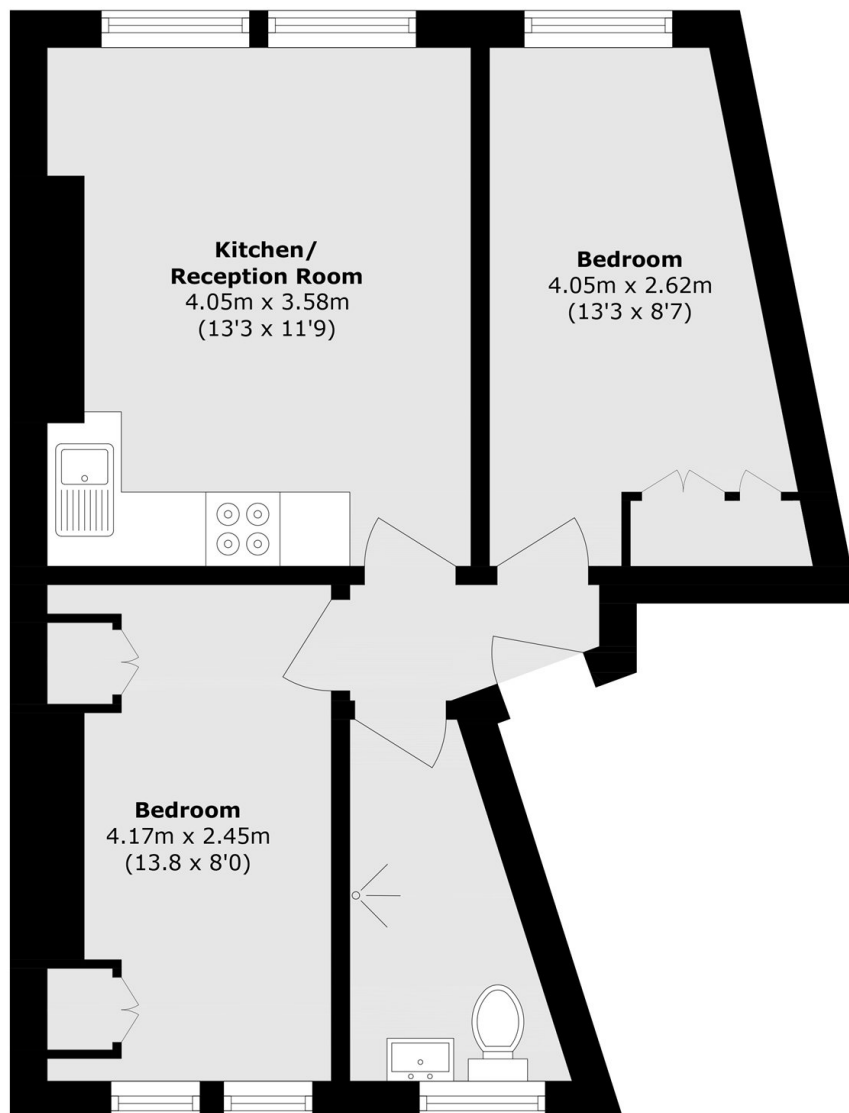

Total area (approx.): 40.4 sq. m (434.8 sq. ft)