



Rathbone Market, E16

£285,000

A one-bedroom, one-bathroom apartment in Rathbone Market. The property features a spacious open-plan reception room, a private balcony, an allocated parking space in an underground car park, communal roof terrace and modern finishes throughout.

Rathbone Market is located just 0.2 miles from Canning Town Station, providing excellent transport links across the City.

Features

- Modern Throughout
- Private Balcony
- Allocated Parking
- Open Plan Reception
- Communal Roof Terrace
- Bike Storage

Rathbone Market, London, E16

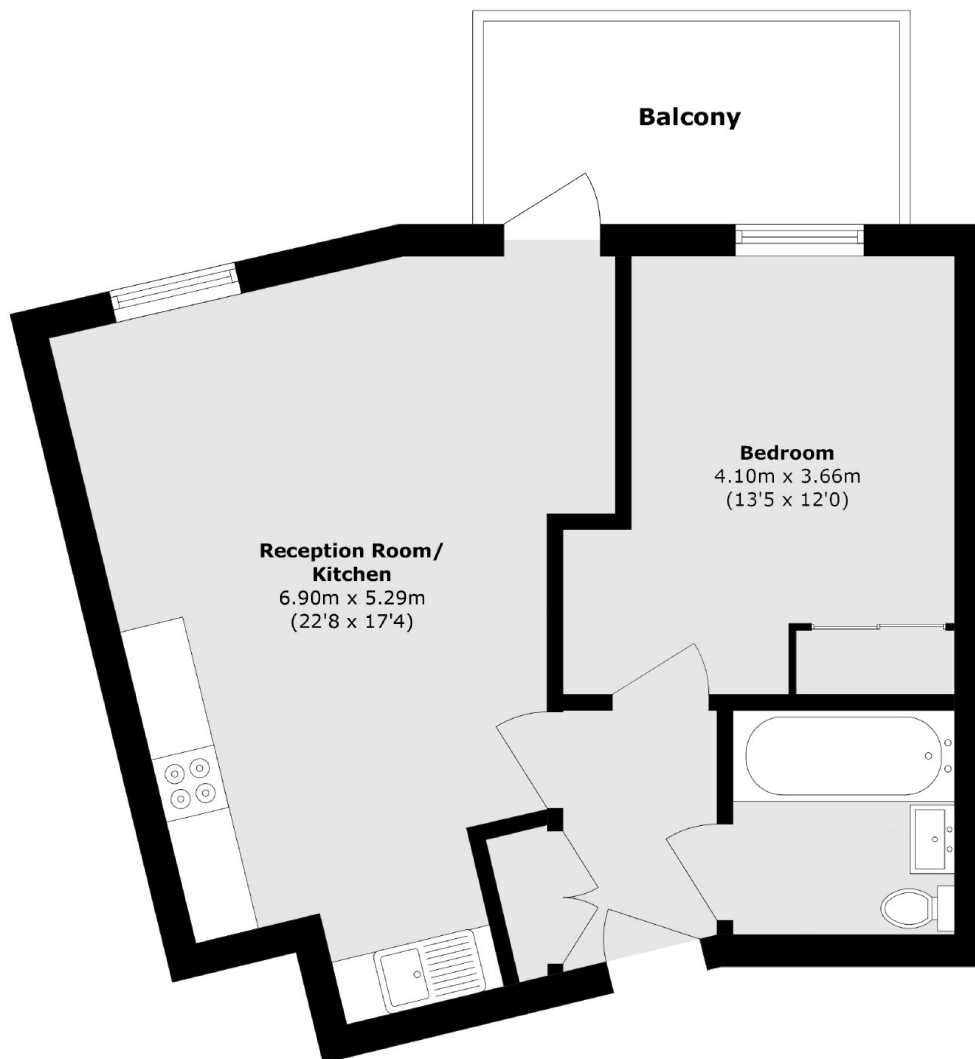

Total area (approx.): 50.1 sq. m (539.2 sq. ft)

Balcony area (approx.): 7.3 sq. m (78.5 sq. ft)