



## Booth Road, E16

### £425,000

Offered to the market on a chain free basis is this two bedroom property in a sought after riverside home. The property includes a private terrace, an additional balcony over looking the Thames, two double bedrooms, allocated parking and a concierge service.

Booth Road is just 0.3 miles from Pontoon Dock DLR station which offers great links around the City. City Airport is also just 0.9 miles from the development.

### Features

- River Facing
- Two Balconies
- Allocated Parking
- Concierge Service
- Residents Gym
- Chain Free

# Booth Road, London, E16

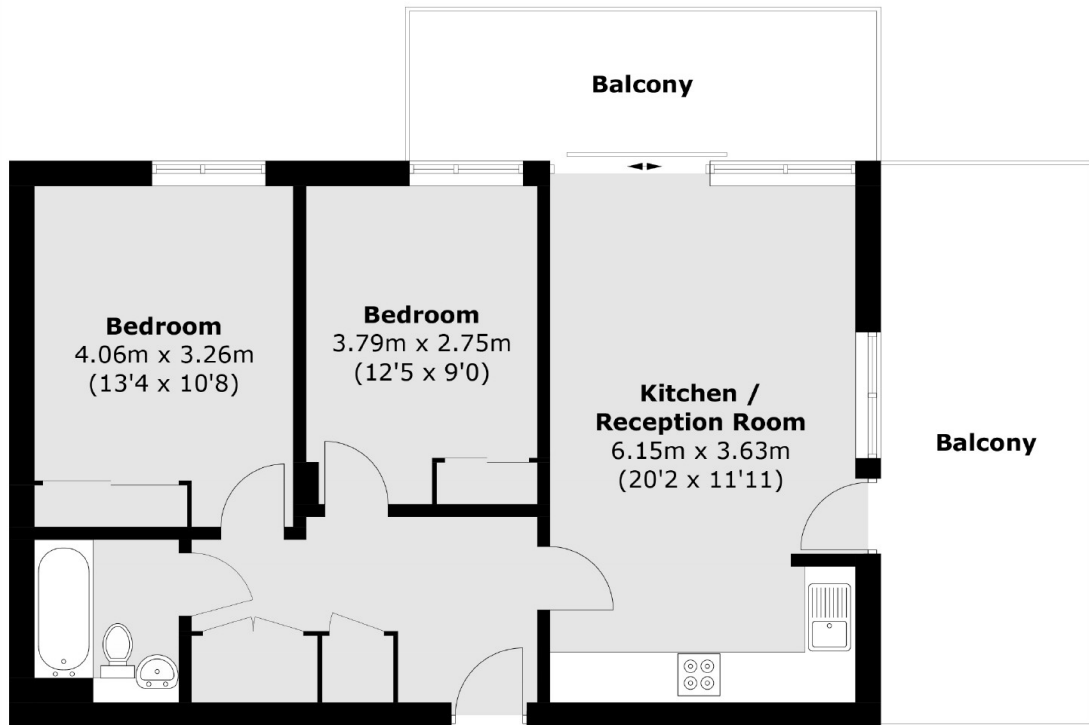

Total area (approx.): 60.6 sq. m (652.3 sq. ft)  
Balcony area (approx.): 26.6 sq. m (286.3 sq. ft)