



Seagull Lane, E16

£450,000

Offered to the market on a chain-free basis, this two-bedroom dock-facing home is set within the sought-after Oceanis Apartments development. The property benefits from an allocated parking space, concierge service, and residents' gym.

Oceanis Apartments is located just 0.2 miles from Custom House Station, providing excellent transport links via the DLR and the Elizabeth Line.

Features

- Dock Facing
- Allocated Parking
- Chain Free
- Residents Gym
- Concierge Services
- Moments To Station

Seagull Lane, London, E16

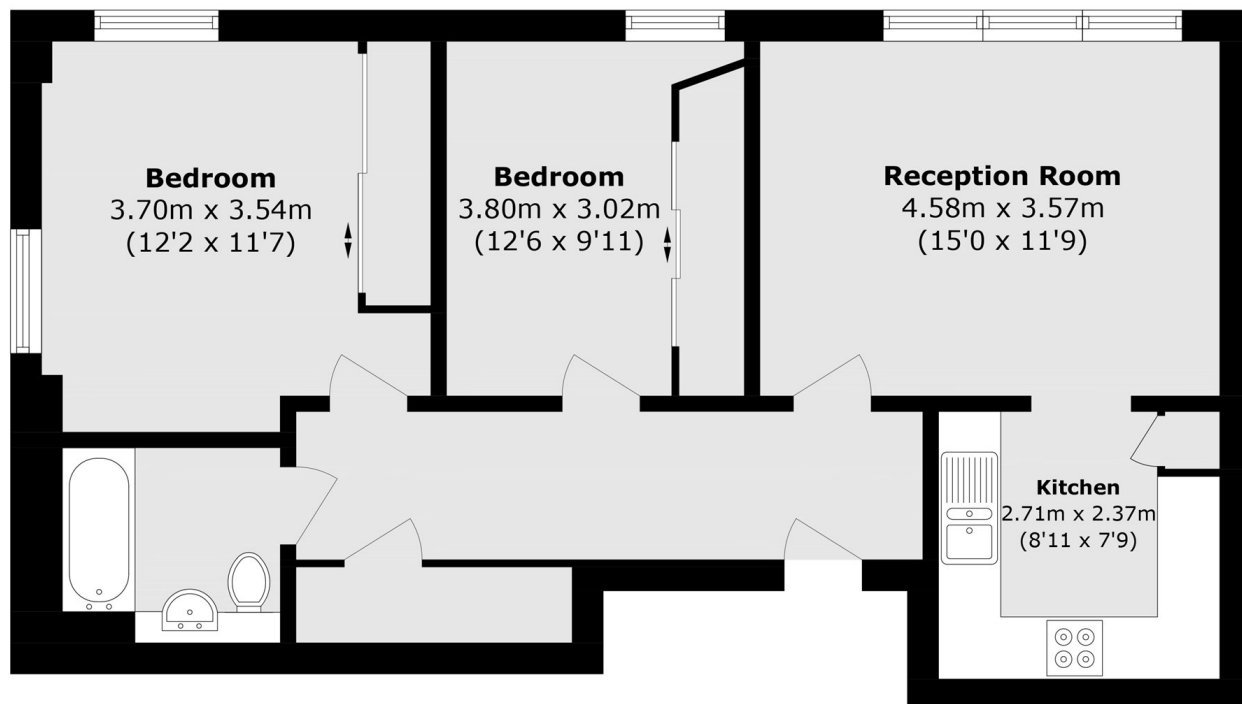

Total area (approx.): 63.9 sq. m (687.8 sq. ft)