



Adler Street, E1

£3,000 Per calendar month

A smart and stylish two double bedroom, two bathroom property available to let, close to Aldgate Station. The development includes hour concierge, leisure facilities and a communal roof terrace.

This hugely popular development is close to transport links with both Aldgate and Whitechapel Stations only moments away. In addition there are a great many bars, restaurants and cafes nearby and trendy Shoreditch is just a short walk away.

Features

- Two Double Bedrooms
- Two Bathrooms
- Wood Flooring
- Leisure Facilities
- Secure Entry
- Aldgate East

Adler Street,
London, E1

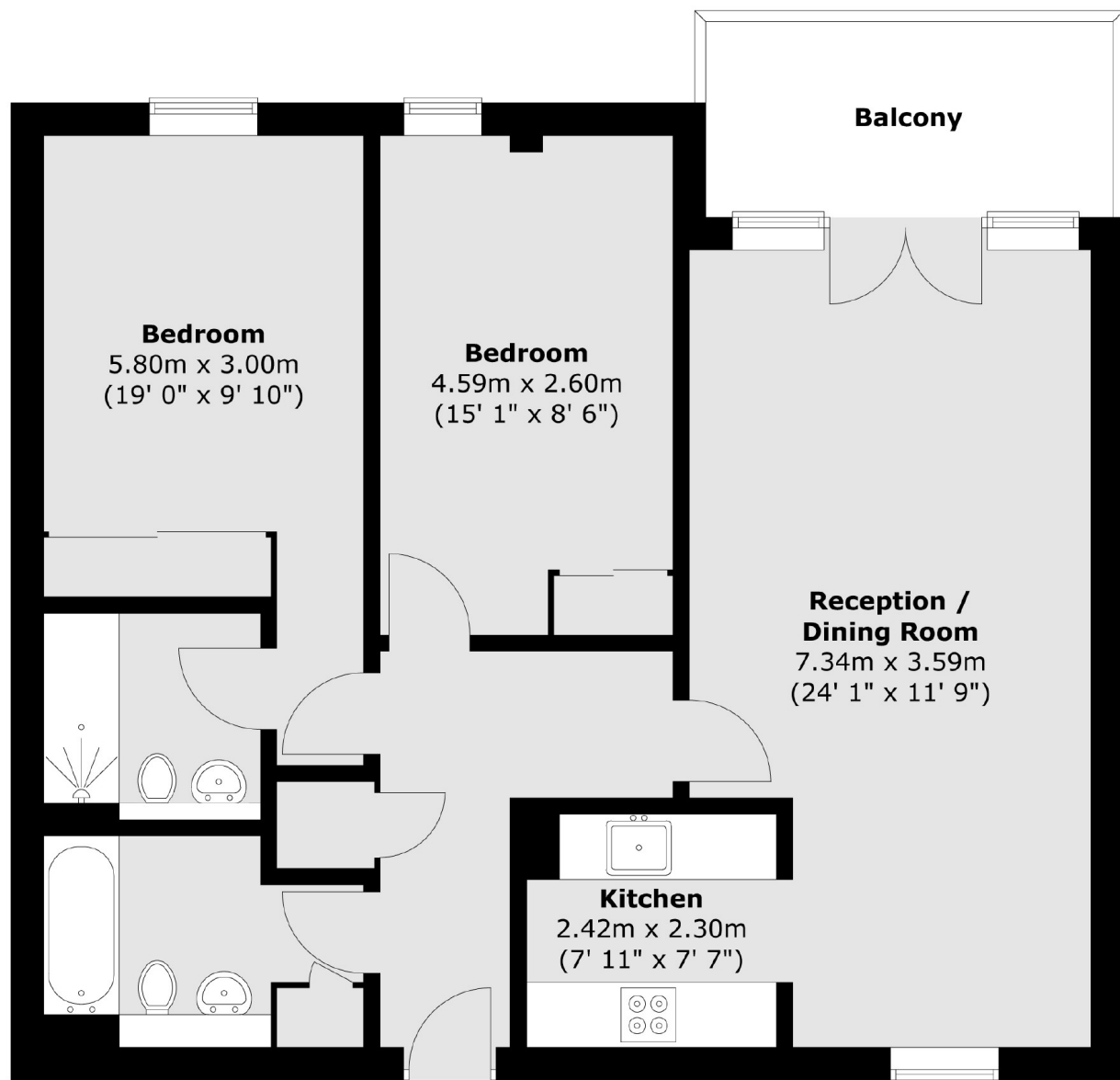

Total area (approx.) : 77.5 sq. m (834 sq. ft)
Total balcony area (approx.) : 6.7 sq. m (72 sq. ft)

Dexters

City
5 Sandys Row
London
E1 7HW
Lettings
020 7392 9111

Energy Rating: C. We aim to make our particulars both accurate and reliable. However they are not guaranteed; nor do they form part of an offer or contract. If you require clarification on any points then please contact us, especially if you're traveling some distance to view. Please note that appliances and heating systems have not been tested and therefore no warranties can be given as to their good working order.

 **RICS** | Regulated
Estate Agent
and Letting Agent

dexters.co.uk