



Myrdle Street, E1

£2,300 Per calendar month

A two double bedroom, two bathroom apartment, The property has an open plan kitchen and living area with private balcony. The master bedroom has an en suite shower room. An ideal property for a professional couple or sharers.

Osmunda Court is located on Myrdle Street which is under half a mile from Aldgate East Underground Station. Trendy Brick Lane and Spitalfields Market is just a short stroll from the flat also.

Features

- Two Double Bedrooms
- Two Bathrooms
- Open Plan Living
- Top Floor
- Fantastic Location
- Aldgate

**Myrdle Street,
London, E1**

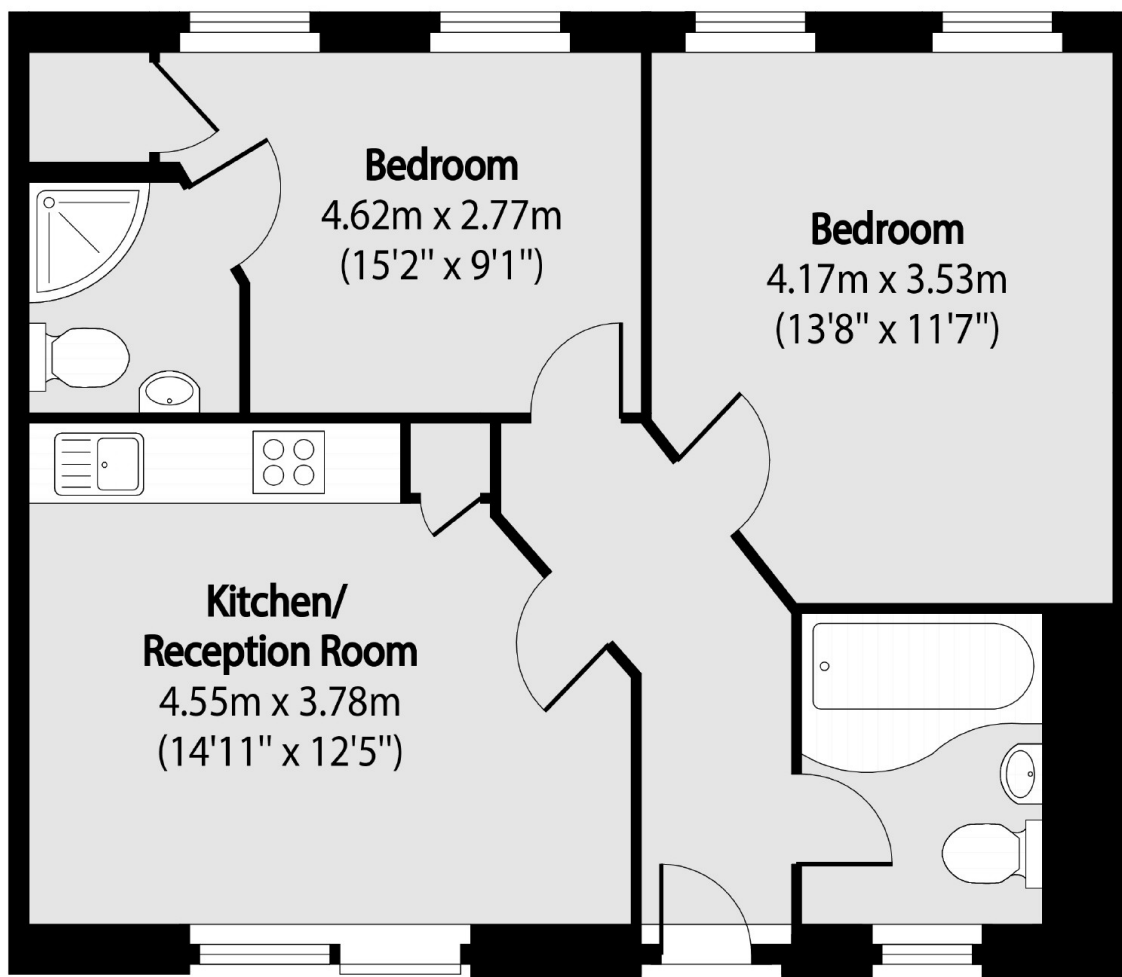

Total area (approx): 53.23 sq m (573 sq. ft)