



Templecombe Road, E9

£400,000

A two double bedroom apartment that measures in excess of 635 Sqft. Located within a secure purpose built block, This property benefits from a separate eat- in kitchen, generous living space and a centralised family bathroom.

This property is located under a quarter of a mile from Mare street and Victoria Park. The many cafes, shops and restaurants of Victoria Park village are half a mile walk as well as vibrant Broadway Market and London Fields.

Features

Two Double Bedrooms
Separate Kitchen
635 Sq Foot
Leasehold
New Flooring
Victoria Park

Templecombe Road,
London, E9

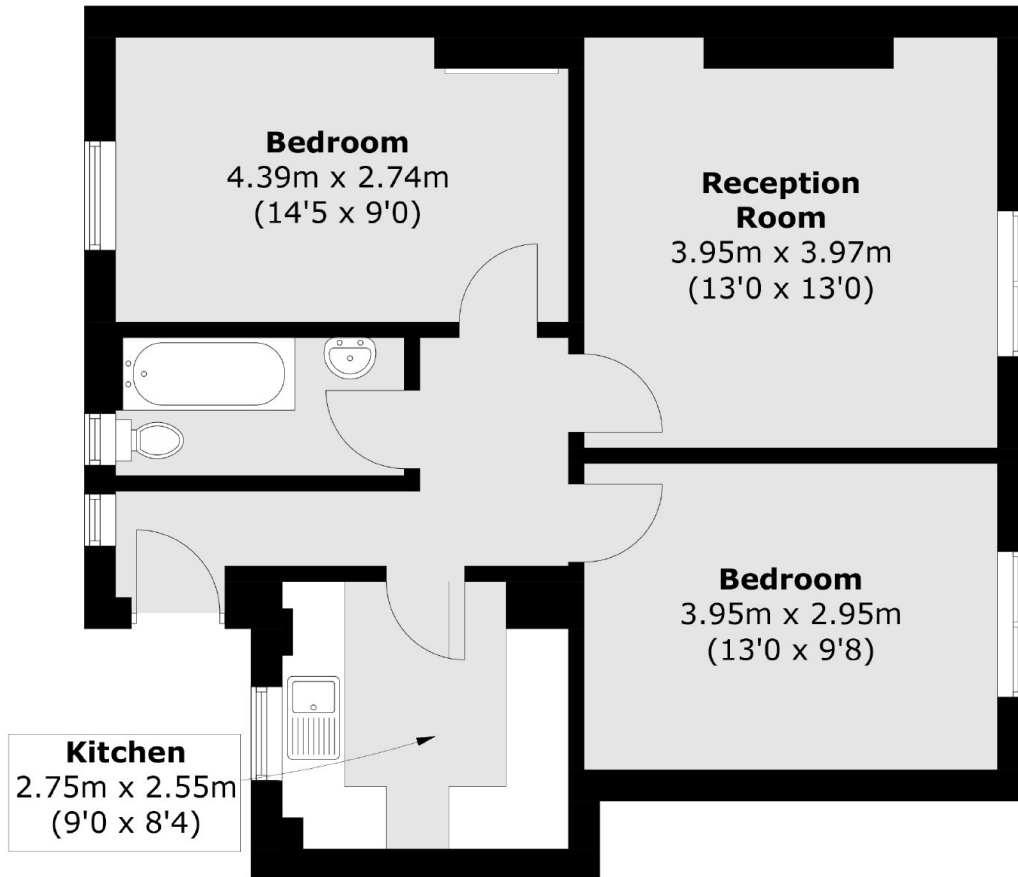

Total area (approx.): 59.3 sq. m (638.3 sq. ft)