

# FLETCHERS

ESTATE AGENTS



## Staveley Road, W4

£1,500 Per week

Set on the highly sought after Staveley Road in the heart of Chiswick, this exceptional four bedroom, two bathroom family home has been finished to an impeccable standard throughout, seamlessly blending elegant design with practical living. A beautiful entrance hall that leads to a stunning reception space with an abundance of natural light and refined finishes. The bespoke kitchen and dining area form the heart of the home, thoughtfully designed for both everyday living and entertaining, with high quality fittings and direct access to the garden.

Upstairs, there are four well appointed bedrooms and two luxurious bathrooms.

To the rear, the private garden is a true highlight, offering a tranquil outdoor retreat ideal for relaxation and entertaining. An impressive, fully fitted outhouse adds valuable additional space, perfect for a home office, gym, studio or guest accommodation.



Set on the highly sought after Staveley Road in the heart of Chiswick, this exceptional family home has been finished to an impeccable standard, seamlessly blending elegant design with practical living.

Located moments away from excellent transport links, outstanding local schools and the vibrant amenities of Chiswick, this lovely home presents a rare opportunity to acquire a turnkey property on one of W4's most desirable roads.

- Four Double Bedrooms • Fully Fitted Outhouse • Large Garden •
- Period Features • Newly Renovated • Grove Park Area •



# FLETCHERS

ESTATE AGENTS

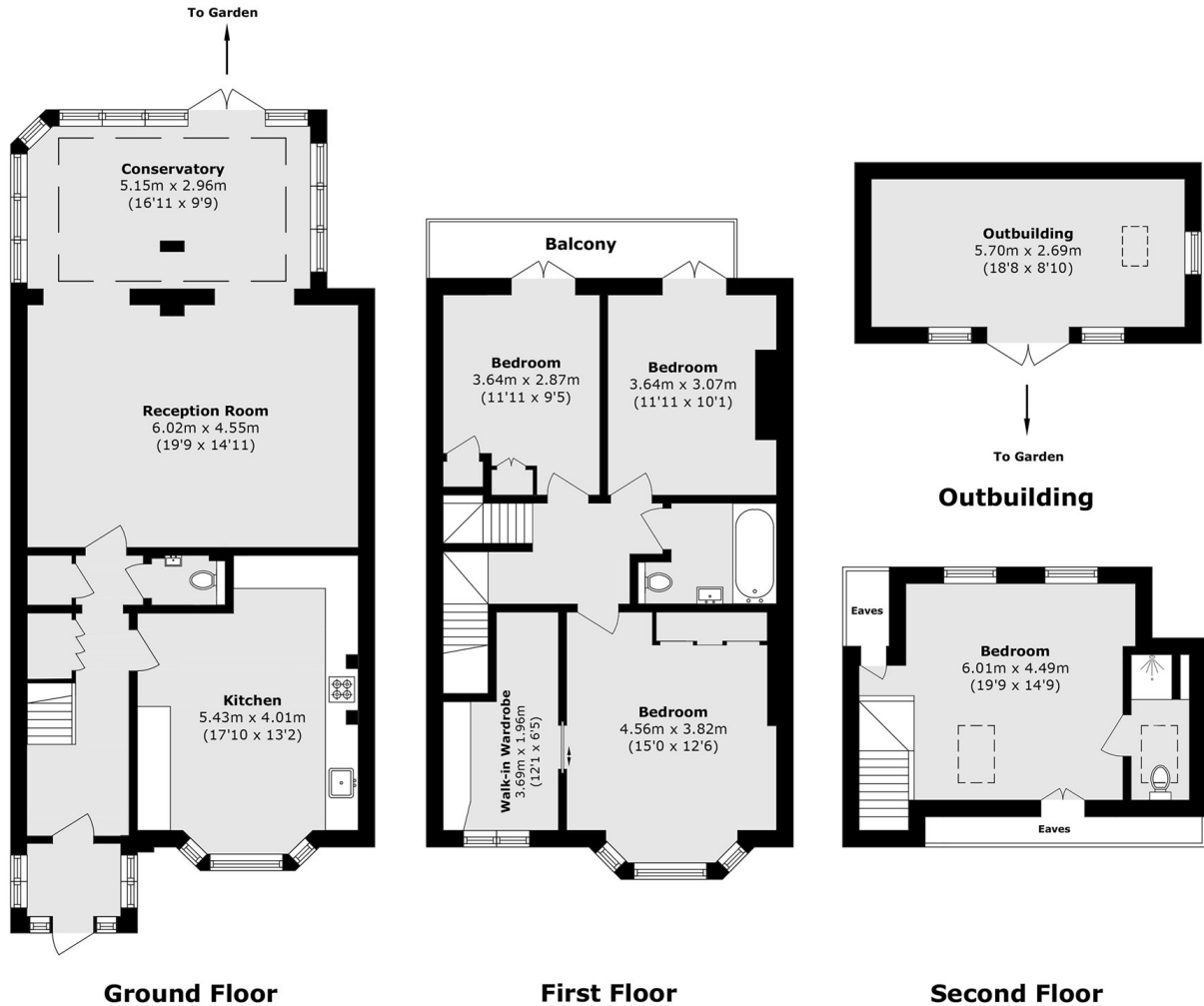

Total area (approx.): 159.9 sq. m (1721.2 sq. ft)  
Outbuilding area (approx.): 15.3 sq. m (164.7 sq. ft)  
Balcony area (approx.): 4.7 sq. m (50.6 sq. ft)  
(Excluding Eaves)

Fletchers Chiswick High Road Lettings  
86 Chiswick High Road  
Chiswick  
London  
W4 1SY  
020 8742 4100

Energy Rating: D We aim to make our particulars both accurate and reliable. However they are not guaranteed; nor do they form part of an offer or contract. If you require clarification on any points then please contact us, especially if you're traveling some distance to view. Please note that appliances and heating systems have not been tested and therefore no warranties can be given as to their good working order