

# FLETCHERS

ESTATE AGENTS



## Stonehill Road, W4

£485 Per week (£2,100 pcm)

This two double bedroom flat offers a fully fitted modern kitchen, an open plan reception with wood floors and doors opening out onto a patio garden, a modern bathroom, and master bedroom with en-suite. The property also benefits from off street parking.

Millennium house is located close to Chiswick High Road and Gunnersbury station.

- Two Bedrooms • Outside Patio • Close to Gunnersbury Station • Modern finish • Storage • En suite •

# FLETCHERS

ESTATE AGENTS

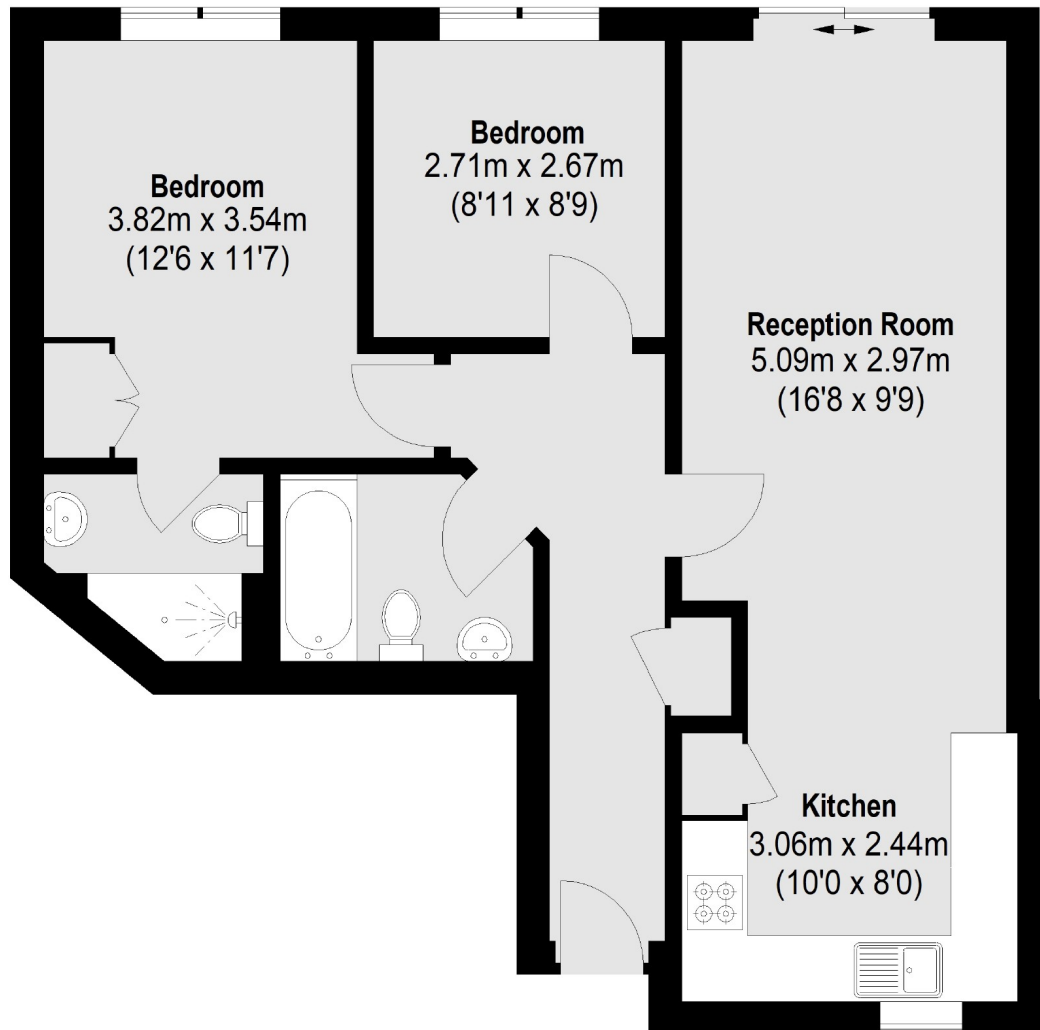

Total area (approx.): 61.89 sq. m (666 Sq. ft)

Fletchers Chiswick High Road Lettings  
86 Chiswick High Road, Chiswick, London, W4 1SY  
020 8742 4100  
[chiswicklettings@fletcherstates.com](mailto:chiswicklettings@fletcherstates.com)

Energy Rating: C. We aim to make our particulars both accurate and reliable. However they are not guaranteed; nor do they form part of an offer or contract. If you require clarification on any points then please contact us, especially if you're traveling some distance to view. Please note that appliances and heating systems have not been tested and therefore no warranties can be given as to their good working order.