

# FLETCHERS

ESTATE AGENTS



## Colonial Drive, W4

£600,000

A bright and spacious modern build apartment set within a short walk of Chiswick High Road. The property offers plenty of living space with two double bedrooms, two bathrooms and an open plan kitchen/reception room which leads out onto a West facing terrace. There is lift access, and an on side concierge.

Ideally located just North of Chiswick Park station (District line), which is just 0.1m away. Chiswick High Road and Turnham Green offer a brilliant selection of shops, cafés and restaurants. By car, the A4/M4 is easy access into and out of London.

- Two Bedrooms • Two Bathrooms • Lift Access • West Facing Terrace • Concierge • Secure Entry •

# FLETCHERS

## ESTATE AGENTS

---

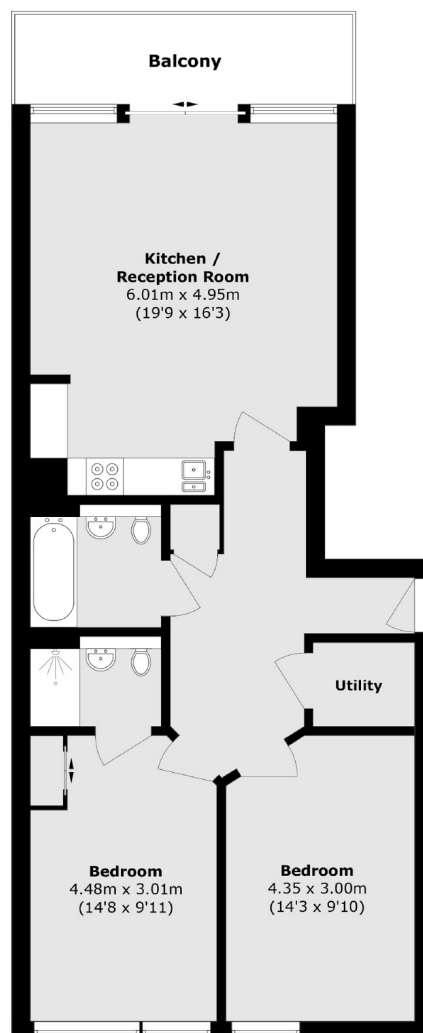

Total area (approx.): 79.1 sq. m (851.4 sq. ft)

Balcony area (approx.): 7.7 sq. m (82.9 sq. ft)

Fletchers Chiswick Turnham Green Sales  
58 Turnham Green Terrace, London, W4 1QP  
020 8987 3000  
[chiswicksales@fletcherestates.com](mailto:chiswicksales@fletcherestates.com)

Energy Rating: C. We aim to make our particulars both accurate and reliable. However they are not guaranteed; nor do they form part of an offer or contract. If you require clarification on any points then please contact us, especially if you're traveling some distance to view. Please note that appliances and heating systems have not been tested and therefore no warranties can be given as to their good working order.