

# FLETCHERS

ESTATE AGENTS



## Bourne Place, W4

£425,000

A fantastic and very large one double bedroom flat on the second floor of this secure apartment block located in the heart of Chiswick. The property is finished to a very good standard and offers a large reception room with wooden floors and Juliet balcony, modern fitted kitchen with walnut style units and black work surfaces, modern bathroom with shower over the bath and a large double bedroom.

Chatsworth Lodge is in a prime spot with immediate access to the High Street with its wonderful array of High Street Brands, supermarkets and great Gastro Pubs. Turnham Green tube station is also within easy walking distance.

- Double Bedroom • Bathroom • Reception Room • Fitted and Equipped Kitchen • Juliet Balcony • Underground Parking • Passenger Lift •

# FLETCHERS

ESTATE AGENTS

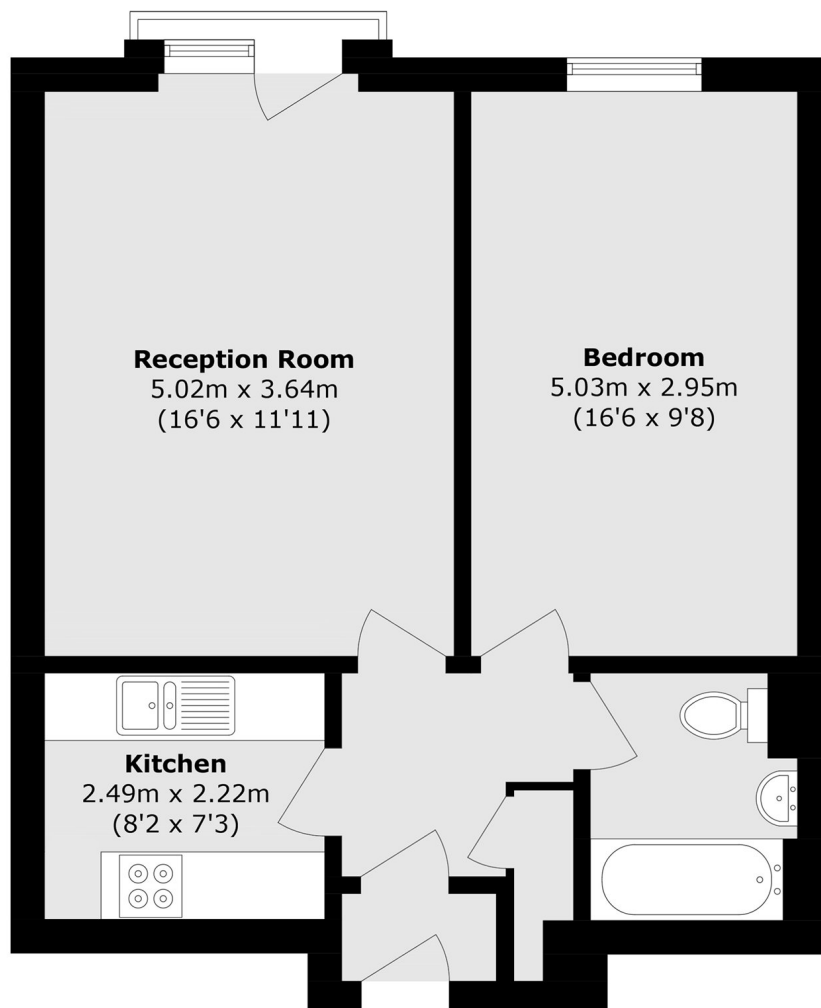

Total area (approx.): 50.6 sq. m (544.6 sq. ft)

Fletchers Brook Green Sales  
144 Shepherds Bush Road, Hammersmith, London, W6 7PB  
020 7603 1415  
[brookgreensales@fletcherstates.com](mailto:brookgreensales@fletcherstates.com)

Energy Rating: C. We aim to make our particulars both accurate and reliable. However they are not guaranteed; nor do they form part of an offer or contract. If you require clarification on any points then please contact us, especially if you're traveling some distance to view. Please note that appliances and heating systems have not been tested and therefore no warranties can be given as to their good working order.