



COUNCILLOR LANE

MITCHELL  WILLIAMS
E S T A T E A G E N T S



**149a Councillor Lane,
Cheadle, SK8 2JE**

Guide Price £100,000



****IDEAL FIRST TIME BUYER OR BUY TO LET OPPORTUNITY**** A SPACIOUS first floor flat situated in a CONVENIENT LOCATION close to SHOPS and LOCAL AMENITIES and within CLOSE PROXIMITY of the MOTORWAY NETWORK. APPROX 719 SQ.FT. In brief the accommodation comprises; spacious lounge/dining room, separate kitchen, two double bedrooms and fitted bathroom with white suite. Fitted with upvc double glazing. Offered to the market with the benefit of NO ONWARD CHAIN!

Postcode: SK8 2JE
Tenure:
Council Tax:
Service Charge:
Floor Area: 719



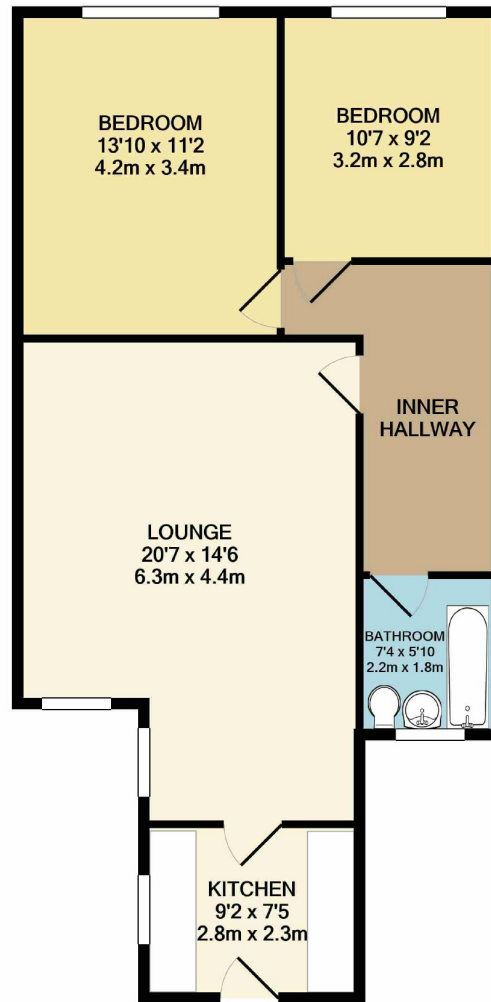

TOTAL APPROX. FLOOR AREA 719 SQ.FT. (66.8 SQ.M.)

Whilst every attempt has been made to ensure the accuracy of the floor plan contained here, measurements of doors, windows, rooms and any other items are approximate and no responsibility is taken for any error, omission, or mis-statement. This plan is for illustrative purposes only and should be used as such by any prospective purchaser. The services, systems and appliances shown have not been tested and no guarantee as to their operability or efficiency can be given
Made with Metropix ©2019

You may download, store and use the material for your own personal use and research. You may not republish, retransmit, redistribute or otherwise make the material available to any party or make the same available on any website, online service or bulletin board of your own or of any other party or make the same available in hard copy or in any other media without the website owner's express prior written consent. The website owner's copyright must remain on all reproductions of material taken from this website.