

Harrowby Street, W1H

£575 Per week

A modern one bedroom apartment on the second floor of this portered building on Harrowby Street. The flat has reception room, open-plan kitchen, double bedroom and bathroom.

Marble Arch Apartments is a well-maintained purpose built building with central heating, lifts and 24 hour portage. Both Regent's and Hyde Park are within half a mile's walk, as are Baker Street, Marylebone and Marble Arch underground stations.

Features

- Lift And Porter
- One Bedroom
- One Bathroom
- Modern Finish
- Furnished

**Harrowby Street,
London, W1H**

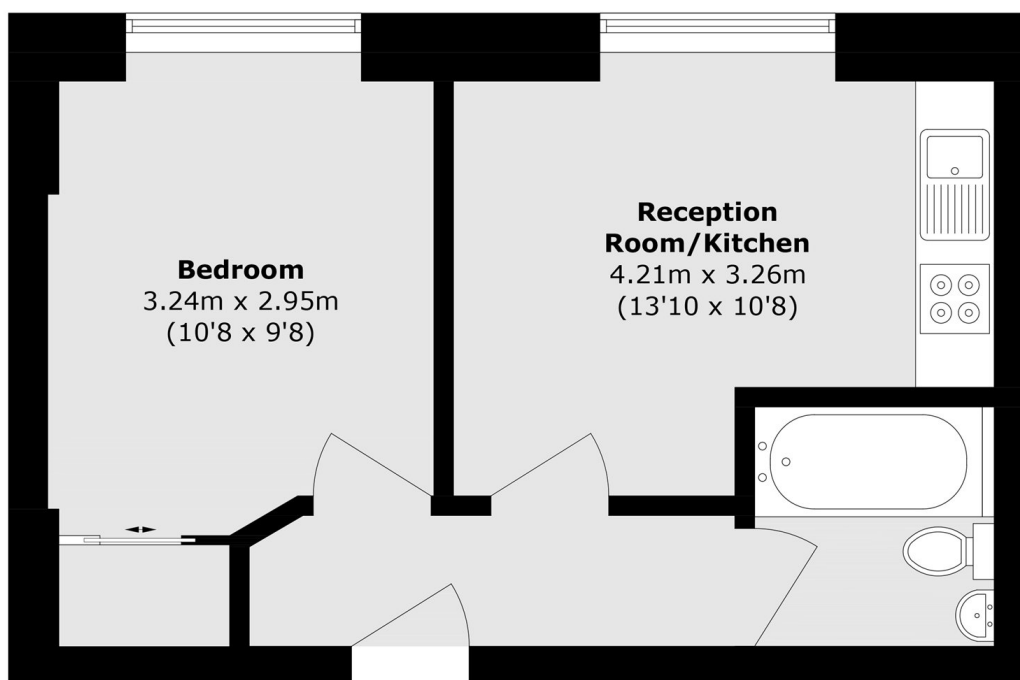

Second Floor

Total area (approx.): 32.8 sq. m (353.0 sq. ft)