



Balcombe Street, NW1

£575,000

A one bedroom apartment situated in a Georgian building in the Dorset Square Conservation area of Marylebone.

Balcombe Street is a quiet street located just north of Dorset Square and under 10 minutes from Regent's Park. It is one of the prime roads of this sought after area, conveniently located between both Marylebone Mainline station and Baker Street Underground station

Features

Bedroom
Reception Room
Kitchen
Shower Room

Balcombe Street, London, NW1

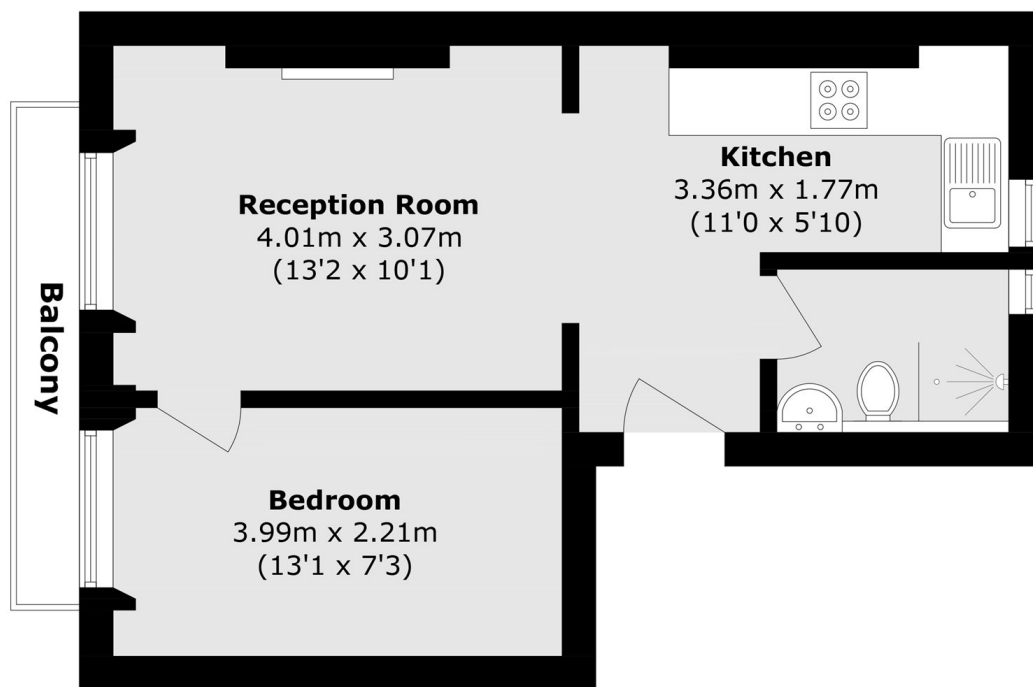

Total area (approx.): 35.3 sq. m (379.9 sq. ft)
Balcony area (approx.): 2.4 sq. m (25.8 sq. ft)