



Parsons Green, SW6

£285,000

A well-finished second floor studio apartment in an attractive period block. Located in Fulham's most sought after location of Parsons Green.

Situated on the outskirts of Parsons Green, the apartment benefits from close proximity to Parsons Green tube station. As well as the abundance of shops and restaurants which compliment the beautiful green.

Features

- Prime Location
- Period Block
- Transport Links
- Good Finish
- Second Floor
- Studio

Parsons Green, London, SW6

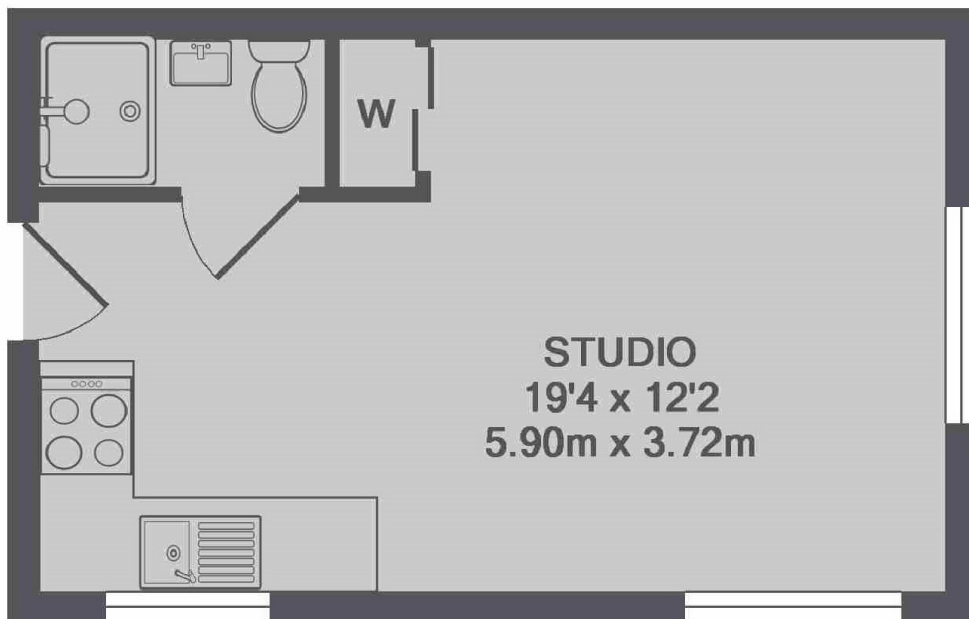

FIRST FLOOR

TOTAL APPROX. FLOOR AREA 239 SQ.FT. (22.2 SQ.M.)