



Pembridge Gardens, W2

£438 Per week

A bright and spacious one bedroom apartment on the second floor (with lift) of this well maintained Period mansion block ideally located on the residential Pembridge Gardens, Notting Hill.

Pembridge Gardens is conveniently located just off Notting Hill Gate and benefits from its many local amenities including the famous 'Coronet' cinema, Egg Break and Kensington Gardens/Hyde Park is just a short walk.

Features

- One Double Bedroom
- Separate Kitchen
- Wood Floors
- Second Floor
- Mansion Building
- Professionally Managed

Pembridge Gardens,
London, W2

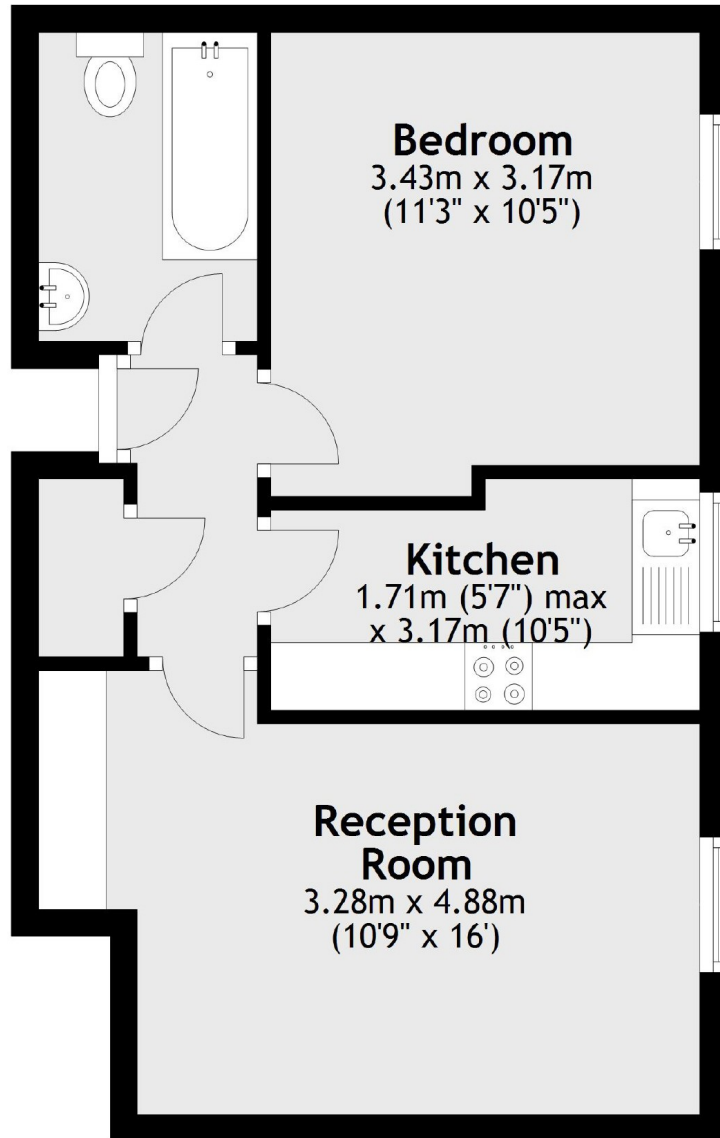

Total area: approx. 37.2 sq. metres (400.4 sq. feet)