



## St. Georges Square, SW1V

£483 Per week

A bright and spacious one double bedroom flat on the second floor of this smartly presented stucco fronted period building in the heart of Pimlico with wood floors throughout.

Located at the northern end of the garden square, you are very close Pimlico station as well as Victoria station making the journey to central London very quick. St. Georges square is surrounded by boutique shops and cafes.

### Features

Second Floor  
Large Living Room  
High Ceiling's  
One Double Bedroom  
Excellent Location  
Separate Kitchen

St. Georges Square,  
London, SW1V

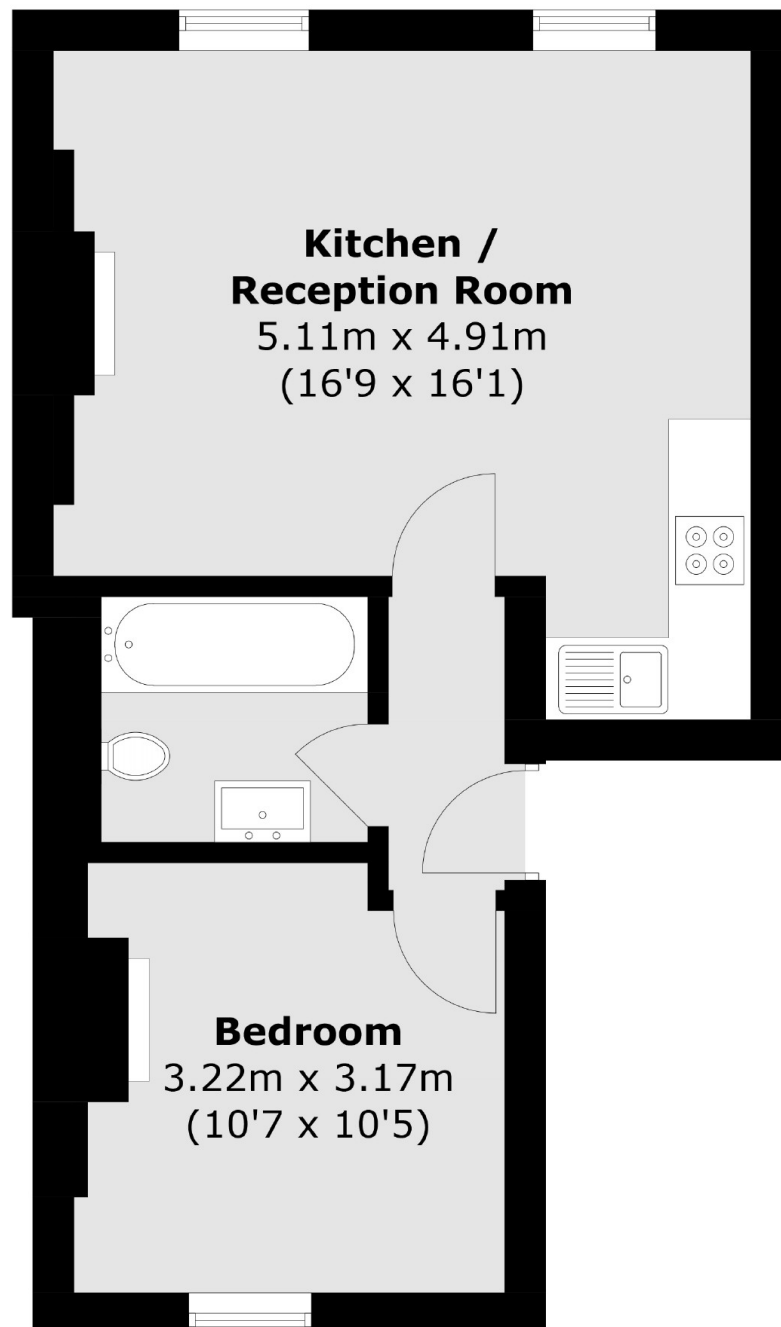

Total area (approx.): 38.2 sq. m (411.2 sq. ft)

**Dexters**

Pimlico  
42 Denbigh Street  
London  
SW1V 2ER  
Lettings  
020 7976 5200

Energy Rating: . We aim to make our particulars both accurate and reliable. However they are not guaranteed; nor do they form part of an offer or contract. If you require clarification on any points then please contact us, especially if you're traveling some distance to view. Please note that appliances and heating systems have not been tested and therefore no warranties can be given as to their good working order.

 **RICS** | Regulated  
Estate Agent  
and Letting Agent

[dexters.co.uk](https://www.dexters.co.uk)