



Rosary Gardens, SW7

£750 Per week

Dexters



Rosary Gardens, SW7

An excellent two-bedroom flat available for rent in South Kensington. Located on the second floor of a charming red brick Victorian building, this furnished property features an open-plan kitchen and living room, wood flooring, and modern specifications throughout.

Conveniently located near Gloucester Road and Earls Court Road, this property offers easy access to a diverse selection of cafes, shops, and restaurants. The nearest underground station is Gloucester Road, providing excellent connectivity to the city via the District and Piccadilly lines.

Features

- Two Bedrooms
- One Bathroom
- Open Plan Kitchen
- Spacious Living Room
- Lateral Flat
- Wood Floors



Rosary Gardens, London, SW7

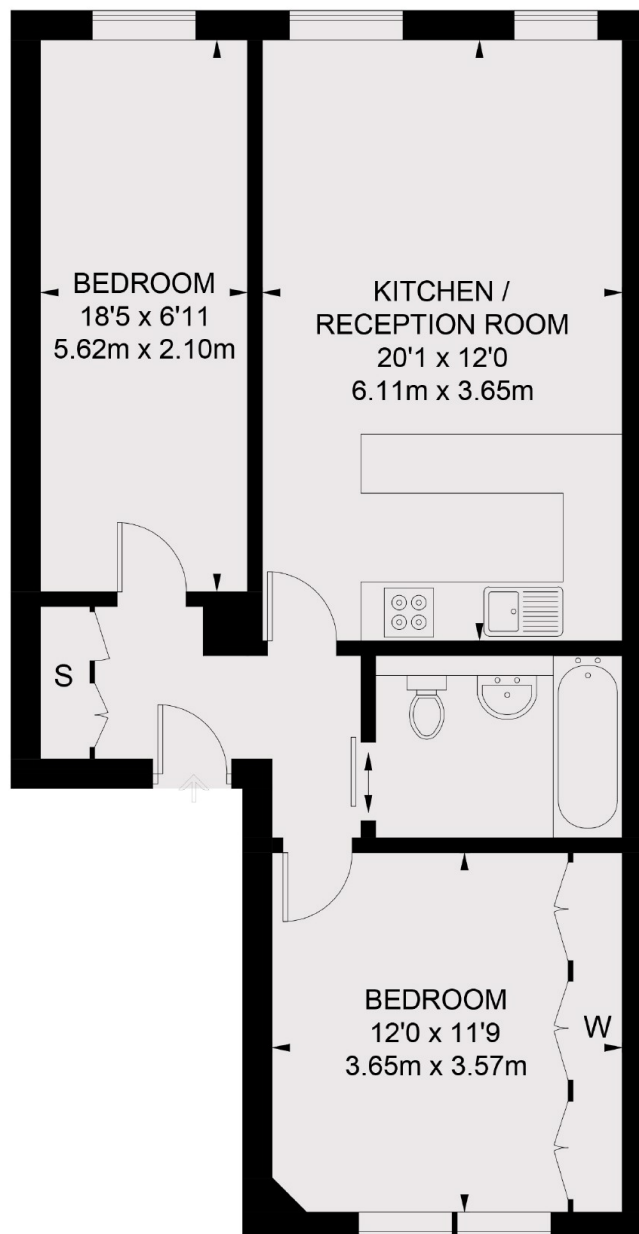

SECOND FLOOR

TOTAL APPROX. FLOOR AREA 640 SQ. FT. (59.5 SQ. M.)

Dexters

South Kensington
144 Old Brompton Road
London
SW7 4NR
Lettings
020 7244 7711

Energy Rating: C. We aim to make our particulars both accurate and reliable. However they are not guaranteed; nor do they form part of an offer or contract. If you require clarification on any points then please contact us, especially if you're traveling some distance to view. Please note that appliances and heating systems have not been tested and therefore no warranties can be given as to their good working order.

 **RICS** | Regulated
Estate Agent
and Letting Agent

[dexters.co.uk](https://www.dexters.co.uk)