



Eardley Crescent, SW5

£600,000

This bright and spacious second floor apartment offers comfortable and stylish living in a prime location, just a short walk from Earl's Court Tube Station and a wide range of local amenities. The property comprises two generously sized bedrooms and a large living and dining area, ideal for both relaxing and entertaining. With an abundance of natural light flooding the space, the apartment feels airy and inviting throughout.

Eardley Crescent is located between Warwick Road and Old Brompton Road. There are many amenities on Old Brompton Road itself, and Earls Court. Access out of London is easy on the A4 and the closest underground is Earls Court.

Features

- Second Floor
- Close To Earls Court Station
- Two Spacious Bedrooms
- Ideal First Time Purchase
- Close To Amenities
- Abundance Of Natural Light

Eardley Crescent, London, SW5

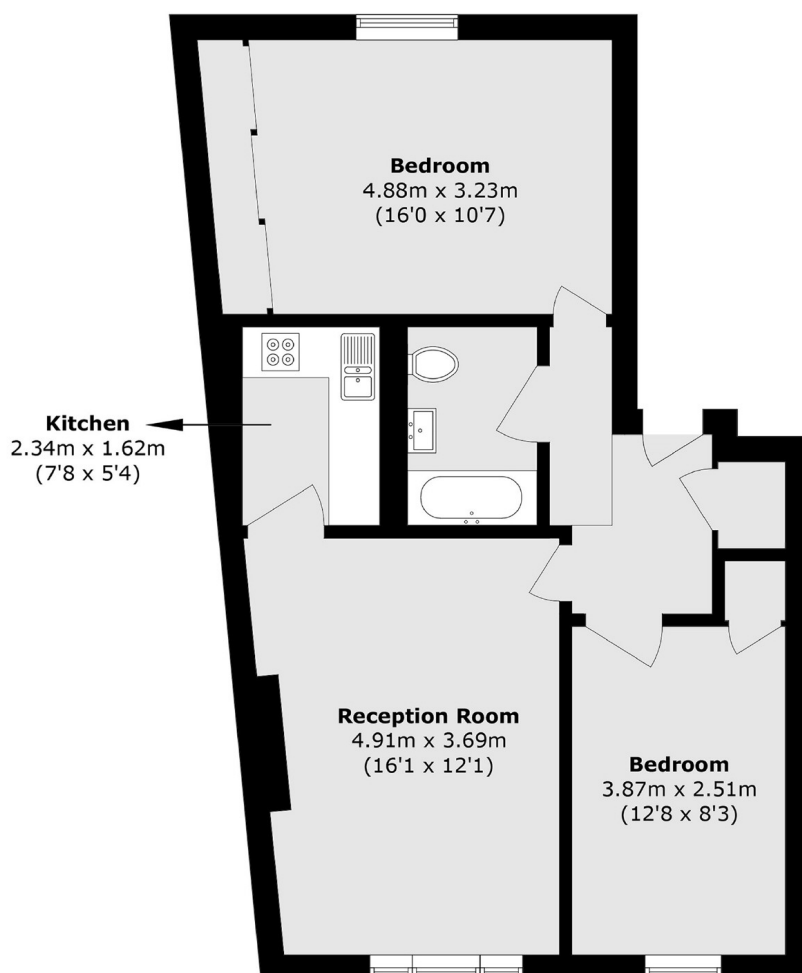

Total area (approx.): 59.3 sq. m (638.3 sq. ft)

Dexters

South Kensington
144 Old Brompton Road
London
SW7 4NR
Sales
0207 838 0108

Energy Rating: C. We aim to make our particulars both accurate and reliable. However they are not guaranteed; nor do they form part of an offer or contract. If you require clarification on any points then please contact us, especially if you're traveling some distance to view. Please note that appliances and heating systems have not been tested and therefore no warranties can be given as to their good working order.

 **RICS** | Regulated
Estate Agent
and Letting Agent

[dexters.co.uk](https://www.dexters.co.uk)