



## Ifield Road, SW10

£500 Per week

A well-presented one-bedroom flat available to rent on the raised ground floor. The property features wood flooring throughout and is ideally suited to a professional individual or couple.

Close to Earl's Court Road and situated just south of Old Brompton Road, the area offers a wide range of shops and cafés, including a 24-hour Tesco supermarket, Marks & Spencer Simply Food, Starbucks, and Wagamama. Earl's Court Underground station is located within a mile, providing convenient transport links.

### Features

- One Bedroom
- Furnished
- Wood Floors
- Separate Kitchen
- Great Location

# Ifield Road, London, SW10

## Ground Floor

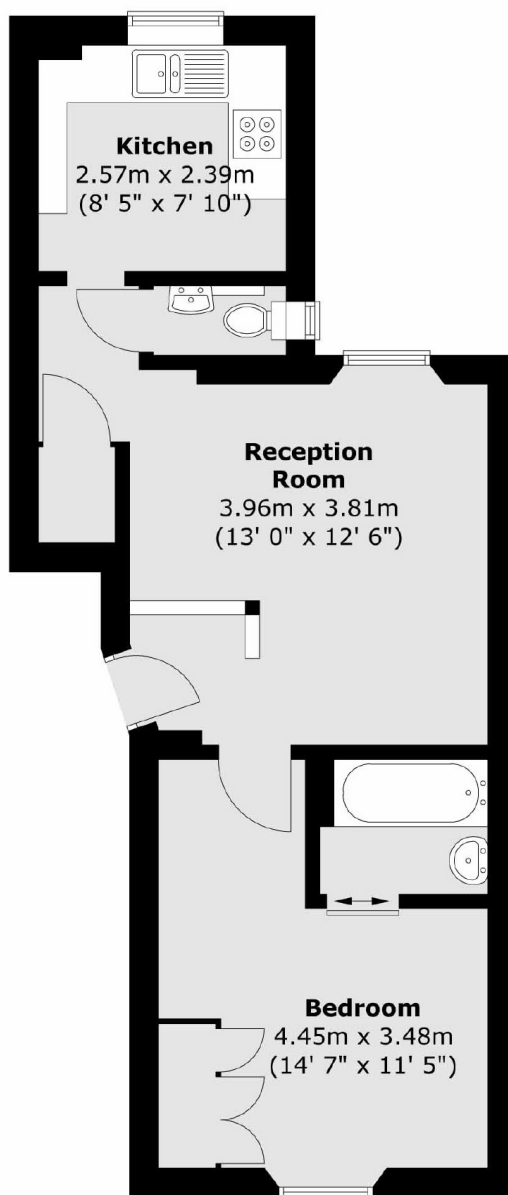

Total area (approx.) : 41.4 sq. m (445 sq. ft)

# Dexters

South Kensington  
144 Old Brompton Road  
London  
SW7 4NR  
Lettings  
020 7244 7711

Energy Rating: D. We aim to make our particulars both accurate and reliable. However they are not guaranteed; nor do they form part of an offer or contract. If you require clarification on any points then please contact us, especially if you're traveling some distance to view. Please note that appliances and heating systems have not been tested and therefore no warranties can be given as to their good working order.

 **RICS** | Regulated  
Estate Agent  
and Letting Agent

[dexters.co.uk](https://www.dexters.co.uk)