



4 Smith Avenue | Inkersall | Chesterfield | S43 3SL

Asking Price Of £189,500

THIS IS A SPACIOUS SEMI DETACHED FAMILY HOME WHICH BOASTS A LARGE FRONT YARD WITH AMPLE OFF ROAD PARKING AND AN ENCLOSED REAR GARDEN WITH A GARAGE, OUTHOUSE AND GARDEN ROOM.

- \* FOUR BEDROOMS
- \* OFFICE/ FIFTH BEDROOM
- \* PRIVATE PARKING FOR SEVEN VEHICLES

- Sizeable Lounge
- Separate Utility Room
- Kitchen with Integral Appliances
- Family Bathroom and Separate WC
- Ample Storage Space

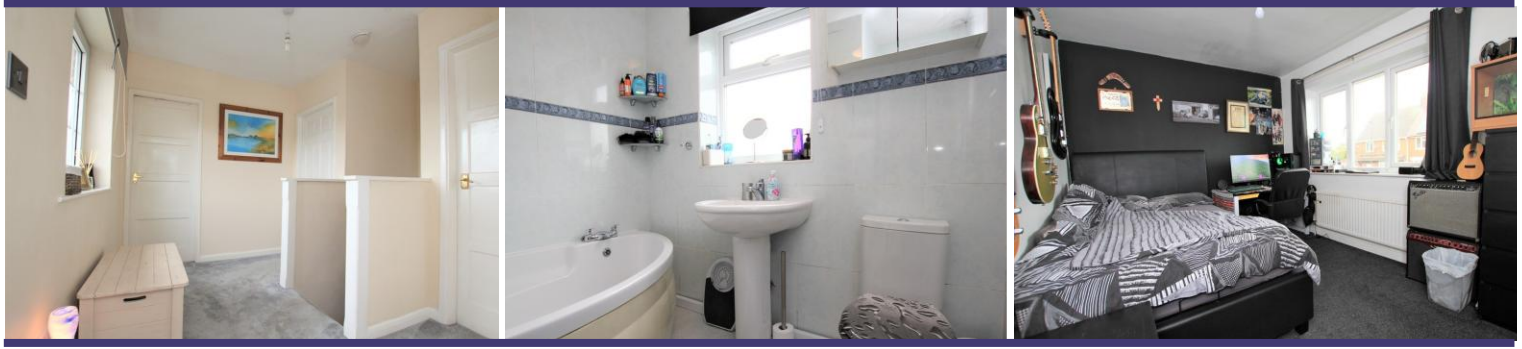

GROUND FLOOR

1ST FLOOR

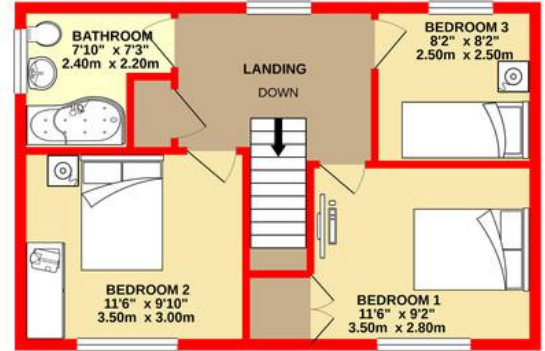
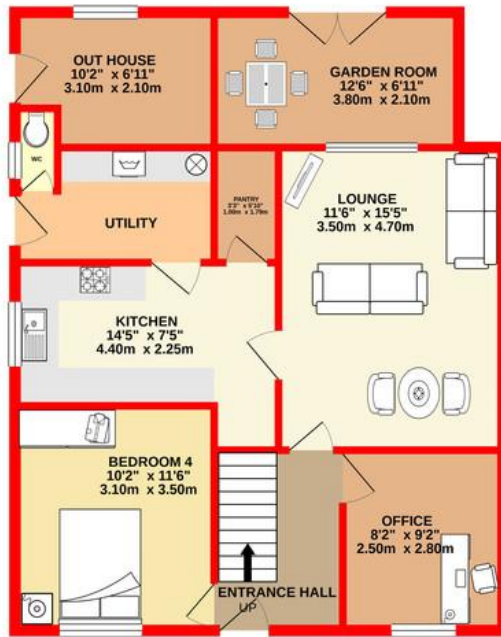
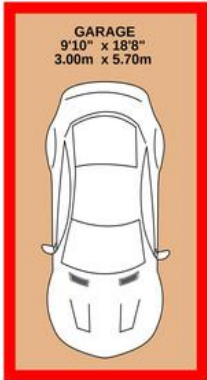

Whilst every attempt has been made to ensure the accuracy of the floorplan contained here, measurements of doors, windows, rooms and any other items are approximate and no responsibility is taken for any error, omission or mis-statement. This plan is for illustrative purposes only and should be used as such by any prospective purchaser. The services, systems and appliances shown have not been tested and no guarantee as to their operability or efficiency can be given.  
Made with Metropix ©2020

## Contact Details

26 Mill Street  
Clowne  
Chesterfield  
Derbyshire  
S43 4JN

[www.villageestateagency.co.uk](http://www.villageestateagency.co.uk)  
[info@villageestateagency.co.uk](mailto:info@villageestateagency.co.uk)  
01246 810519

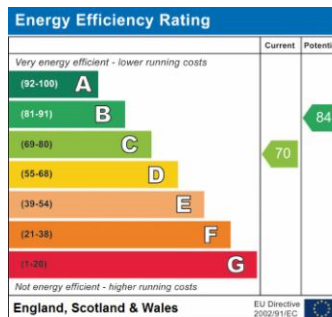

Address:  
4 Smith Avenue, Inkersall

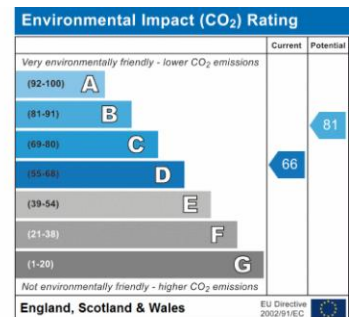

Agents Note: Whilst every care has been taken to prepare these sales particulars, they are for guidance purposes only. All measurements are approximate are for general guidance purposes only and whilst every care has been taken to ensure their accuracy, they should not be relied upon and potential buyers are advised to recheck the measurements