



Harper Road, SE1

£485,000

A highly attractive third-floor flat, offering three well-proportioned double bedrooms. The property features a separate modern kitchen, a spacious living room, with large sash windows, providing excellent natural light, a contemporary shower room, separate WC, and ample built-in storage throughout. Sold with a long lease, the flat also benefits from permit parking.

Harper Road is ideally located, close by to both Borough and Elephant & Castle stations, as well as London Bridge, providing access to the Northern Bakerloo and Jubilee lines. The area has a lively neighbourhood feel, with Borough Market, many independent cafés, restaurants and popular local pubs close by. Everyday amenities, green spaces and cultural attractions are all within easy reach.

Features

- Three Double Bedrooms
- Separate Modern Kitchen Large
- Living Room
- Permit Parking Available
- Great Transport Links
- Long lease

Harper Road, London, SE1

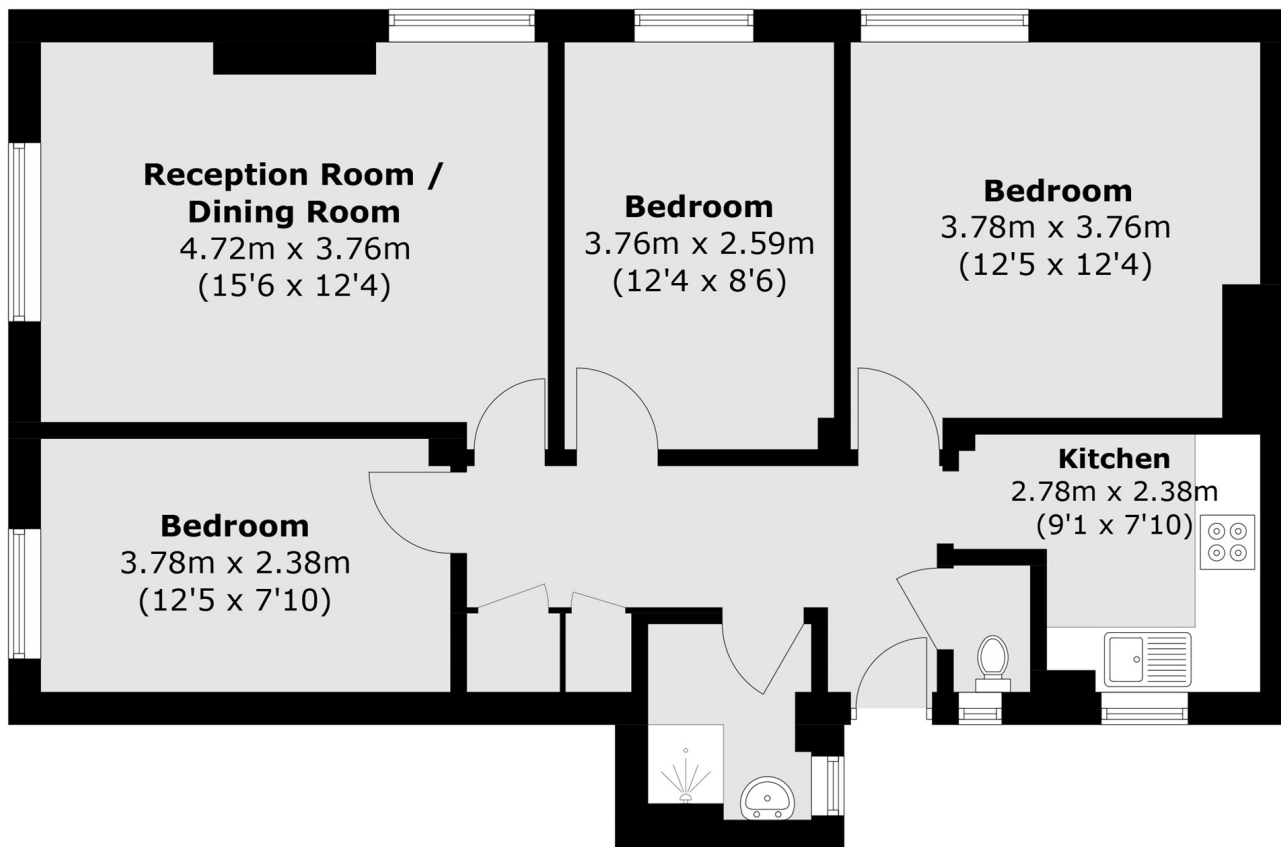

Third Floor

Total area (approx.): 69.4 sq. m (747.0 sq. ft)