

Great Suffolk Street, SE1

£500,000

A highly attractive modern apartment featuring a spacious living room and a separate, newly fitted kitchen with granite work surfaces and integrated appliances. The property has been recently redecorated and re-carpeted, and offers a generous double bedroom, with ample built-in storage, complemented by a stylish Jack and Jill en-suite bathroom.

Set at the top of Great Suffolk Street, this superbly located apartment is moments from the River Thames, the South Bank, Lower Marsh and The Cut, placing the best of central London within easy reach. There are excellent transport connections, with Southwark, Blackfriars, London Bridge and Waterloo stations all nearby.

Features

- Large One Bedroom Apartment
- Recently Redecorated
- Almost 600 Sq Ft
- Separate Modern Kitchen
- Ample Storage
- Low Service Charges
- Very Central Location

Great Suffolk Street,
London, SE1

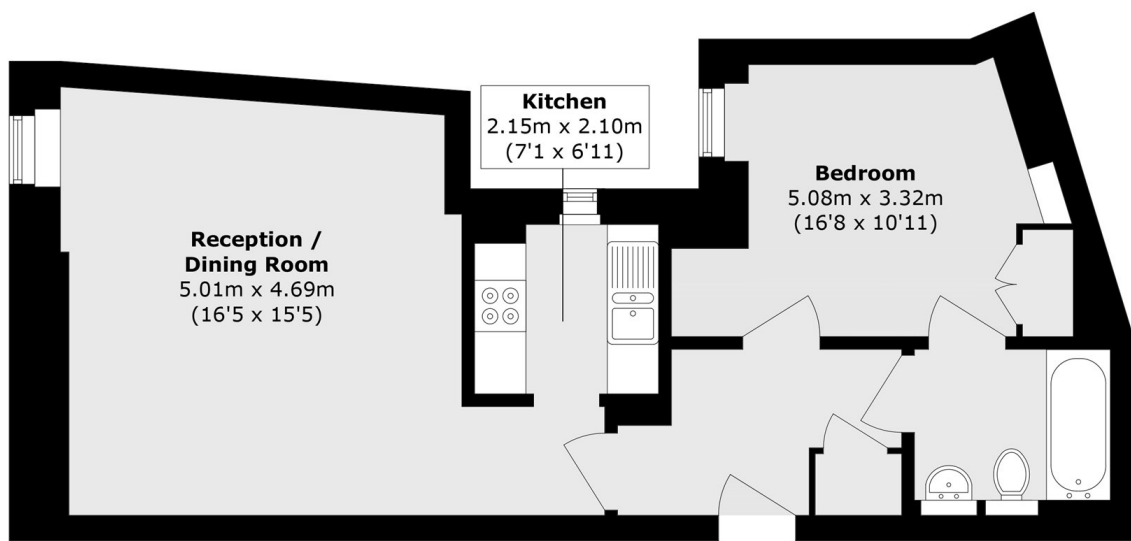

Total area (approx.): 56.9 sq. m (612.4 sq. ft)

Dexters

London Bridge
54 Borough High Street
London
SE1 1XL
Sales
020 7650 5 100

Energy Rating: . We aim to make our particulars both accurate and reliable. However they are not guaranteed; nor do they form part of an offer or contract. If you require clarification on any points then please contact us, especially if you're traveling some distance to view. Please note that appliances and heating systems have not been tested and therefore no warranties can be given as to their good working order.

RICS | Regulated
Estate Agent
and Letting Agent

[dexters.co.uk](https://www.dexters.co.uk)