



## Meakin Estate, SE1

### £375,000

A highly attractive split level apartment offering a generous south-facing reception room, complemented by a separate, fully fitted contemporary kitchen. The property further features a spacious double bedroom with excellent storage, and a modern bathroom. Presented in excellent condition throughout and offered to the market chain-free.

Enviably positioned and discreetly set back from Rothsay Street, the property enjoys a prime location within close proximity of London Bridge station. The renowned Bermondsey Street is moments away, offering an exceptional selection of independent shops, cafés, restaurants and amenities right on the doorstep.

### Features

- Chain Free Sale
- South-Facing
- Split Level
- Communal Gardens
- Permit Parking Available
- Over 550 Sq Ft

# Meakin Estate, London, SE1

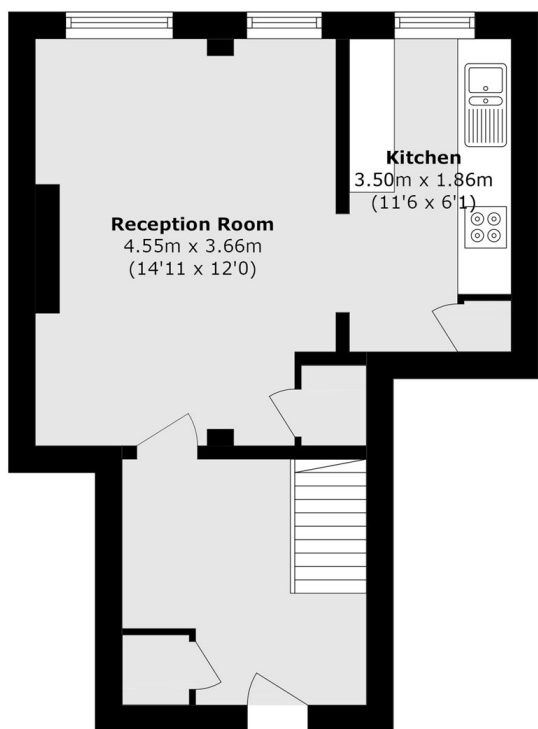

**Ground Floor**

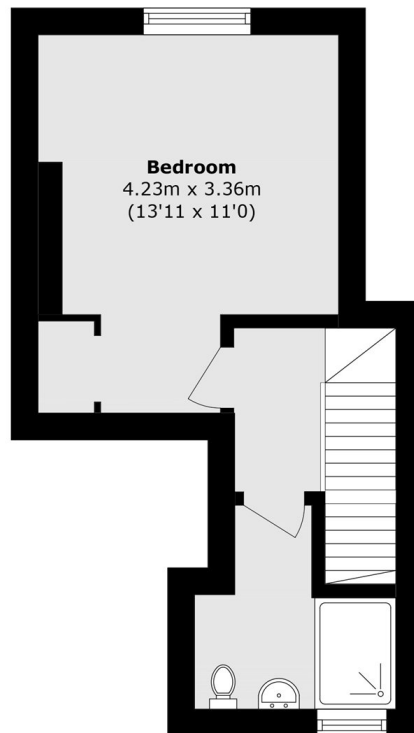

**First Floor**

Total area (approx.): 51.7 sq. m (556.4 sq. ft)