



Old Kent Road, SE1

£375,000

A stunning top-floor flat with character and charm throughout, featuring high ceilings, original feature fireplaces, large sash windows, and wooden floors throughout. The property offers a spacious open-plan living and dining area with a modern fitted kitchen. There are two generous double bedrooms and a large three-piece bathroom. Offered to the market chain free.

Perfectly positioned within walking distance of Borough and Elephant & Castle stations (Zone 1), with access to the Northern and Bakerloo lines. With frequent bus routes into Central London and an abundance of amenities on your doorstep, making this location both convenient and well-connected.

Features

- Victorian Mansion Flat
- Almost 550 Sq Ft
- Two Double Bedrooms
- High Ceilings & Sash Windows
- Communal Roof Terrace
- Chain Free Sale

Old Kent Road, London, SE1

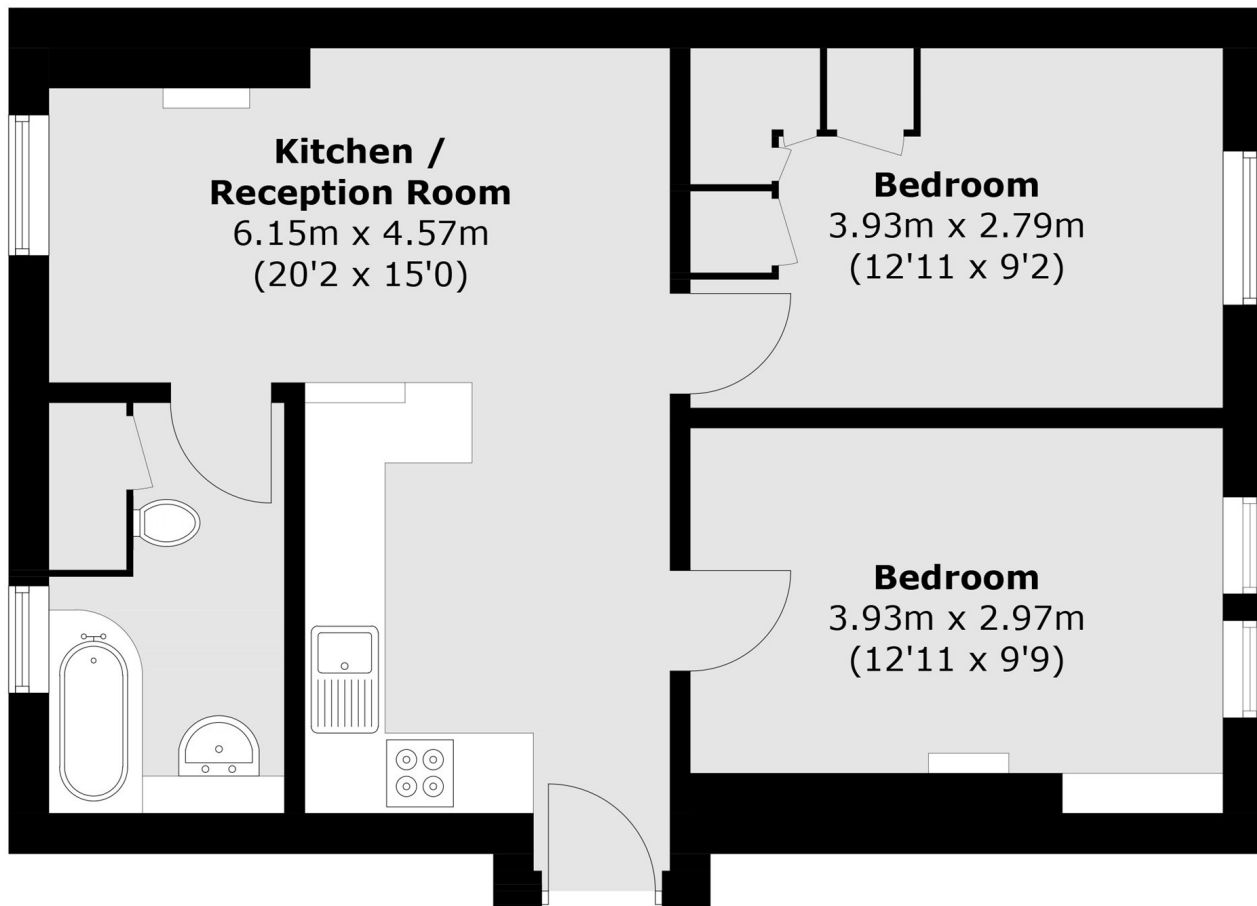

Total area (approx.): 50.7 sq. m (545.7 sq. ft)