



Albert Embankment, SE1

£5,200 Per calendar month

A very spacious and modern two bedroom, two bathroom exclusive riverside apartment with spectacular views. The property offers a stunning reception room with a modern integrated kitchen, wood floors and a private balcony with river views.

The property is situated on Albert Embankment and adjacent to the River, there are plenty of nearby amenities in Vauxhall such as Waitrose and Starbucks not to mention the facilities for the residents of The Corniche.

Features

- Iconic Riverside Location
- Foster & Partner Design
- Residents Pool & Spa
- Skyline Club Lounge
- Luxurious Specification
- 24 Hour Concierge

Albert Embankment, London, SE1

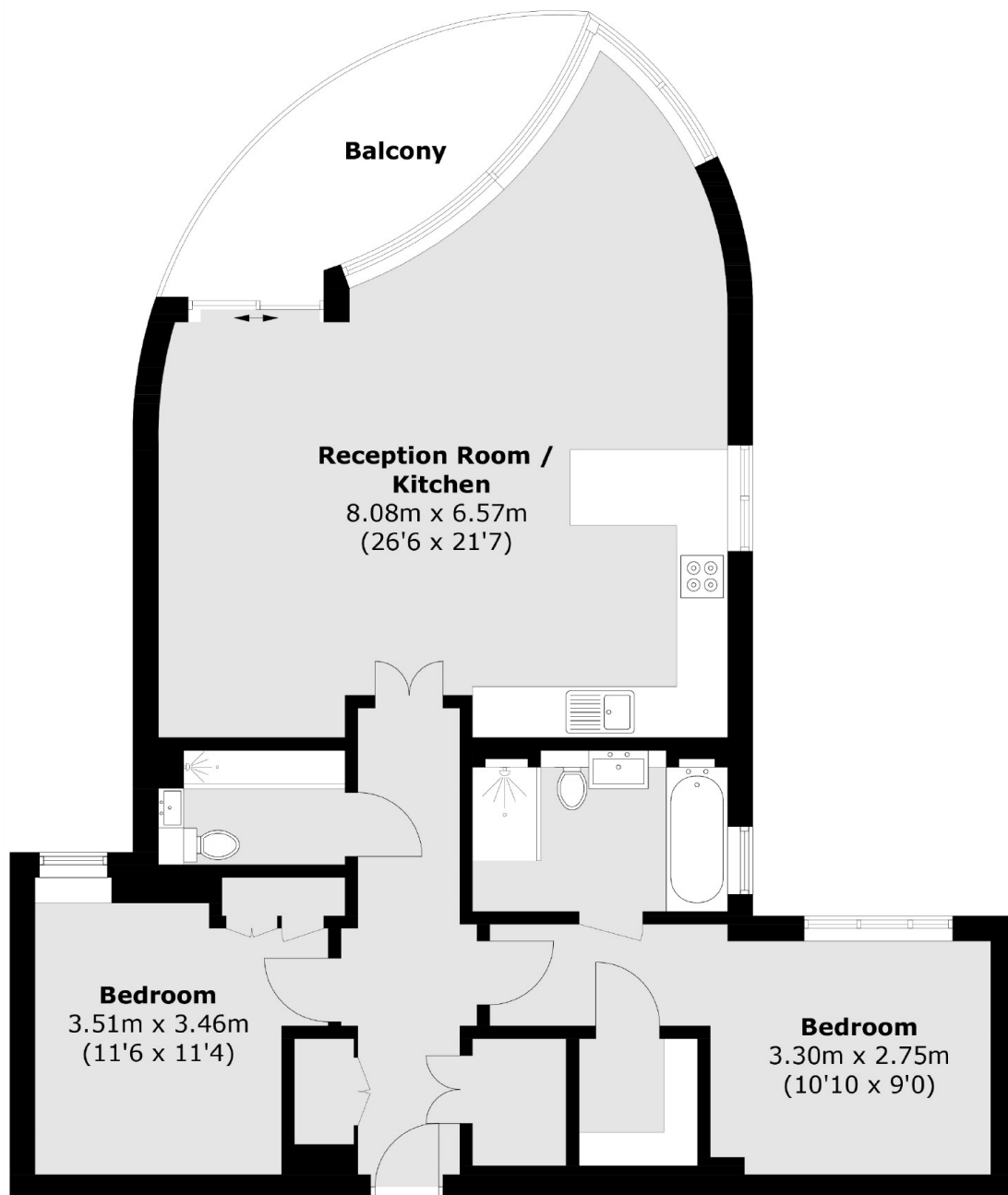

Total area (approx.): 88.8 sq. m (955.8 sq. ft)
Balcony area : 8.3 sq. m (89.3 sq. ft)

Dexters

Kennington
181 Kennington Lane
London
SE11 4EZ
Lettings
020 7650 5103

Energy Rating: B. We aim to make our particulars both accurate and reliable. However they are not guaranteed; nor do they form part of an offer or contract. If you require clarification on any points then please contact us, especially if you're traveling some distance to view. Please note that appliances and heating systems have not been tested and therefore no warranties can be given as to their good working order.

 **RICS** | Regulated
Estate Agent
and Letting Agent

[dexters.co.uk](https://www.dexters.co.uk)