

## Davidson Gardens, SW8

£3,000 Per calendar month

A spacious and well presented three double bedroom apartment ideally located close to Nine Elms tube station. The property also consists of a large reception room, separate kitchen and there is also the added benefit of a shared roof terrace.

The property is ideally positioned for the many amenities of Wandsworth Road, a large Sainsbury's, Nine Elms Station (0.1 miles) as well as the excellent transport links of Vauxhall Station (Victoria Line, National Rail, and bus station).

### Features

- Three Double Bedrooms
- Large Reception Room
- Separate Kitchen
- Available Furnished
- Communal Roof Terrace
- Great Location

# Davidson Gardens, London, SW8

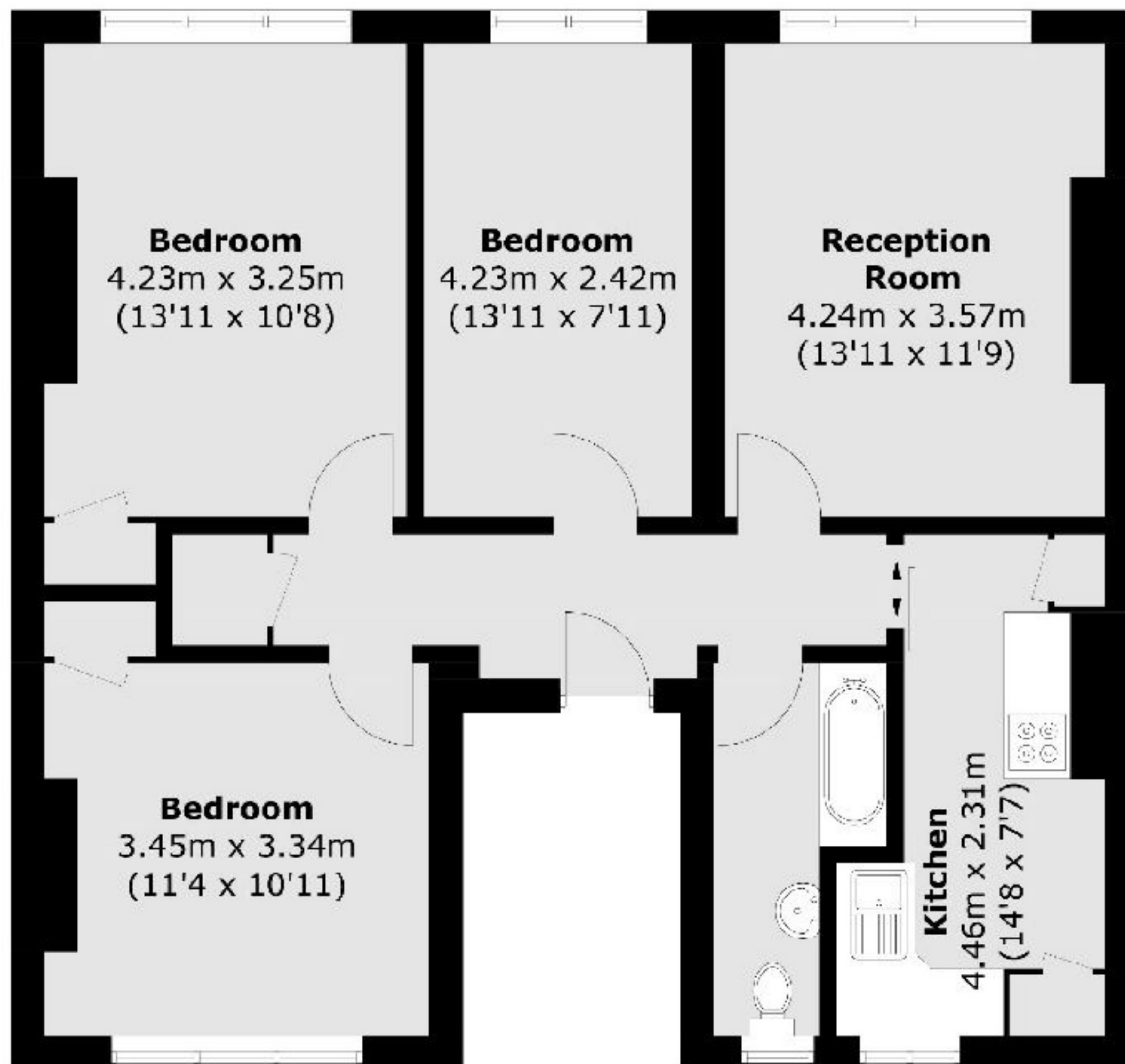

## Second Floor

Total area (approx.): 76.5 sq. m (823.4 sq. ft)

# Dexters

Kennington  
181 Kennington Lane  
London  
SE11 4EZ  
Lettings  
020 7650 5103

Energy Rating: C. We aim to make our particulars both accurate and reliable. However they are not guaranteed; nor do they form part of an offer or contract. If you require clarification on any points then please contact us, especially if you're traveling some distance to view. Please note that appliances and heating systems have not been tested and therefore no warranties can be given as to their good working order.

 **RICS** | Regulated  
Estate Agent  
and Letting Agent

dexters.co.uk