



Baytree Mews, SE17

£950,000

A lovely four bedroom, freehold home in great condition throughout. This flexible home has an abundance of reception space, benefitting from a spacious kitchen/diner and a separate reception room on the first floor. There is a handy study on the ground floor providing work from home space, which could also act as a fourth bedroom. Furthermore there is direct access onto a south facing rear garden, allocated parking to the front, two bathrooms and a separate w/c on the ground floor. Sold with no onward chain

Baytree Mews is a peaceful gated close in zone one, with fabulous access to transport links including many bus links, Elephant and Castle Overground and Underground stations (Bakerloo & Northern Lines). There is a wide range of different shops, supermarkets, bars and restaurants close by as well many bus routes. .

Features

- Four Bedrooms
- Great Condition
- Gated Close
- Excellent Location for Transport
- No Onward Chain
- Two Bathrooms

Baytree Mews, London, SE17

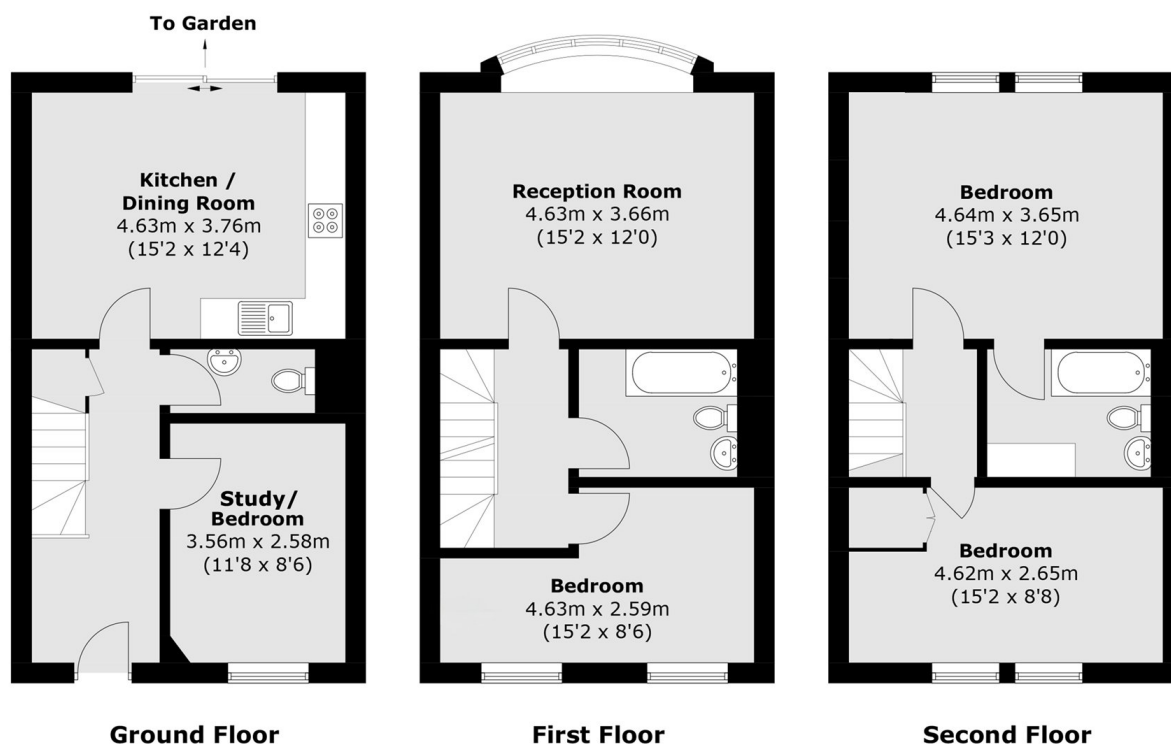

Total area (approx.): 125.0 sq. m (1345.5 sq. ft)