



Reedworth Street, SE11

£430,000

A purpose built top floor flat in need of modernisation throughout. Flooded with natural light the property has a spacious reception room to the front, a bathroom and separate south facing kitchen. The property is being sold with no onward chain and has excellent potential for the next buyer to make it their own.

Quietly located just moments from Kennington Road moments from pubs, eateries and local shops. High in community spirit, this perfect Kennington location has great access to transport links that are unbeatable with Kennington, Oval and Vauxhall stations close by, within a short stroll of Kennington Park and within easy reach of the City and West End.

Features

- Two Bedrooms
- Top floor
- Excellent Location
- Healthy Lease
- Excellent Potential
- No Onward Chain

Reedworth Street, London, SE11

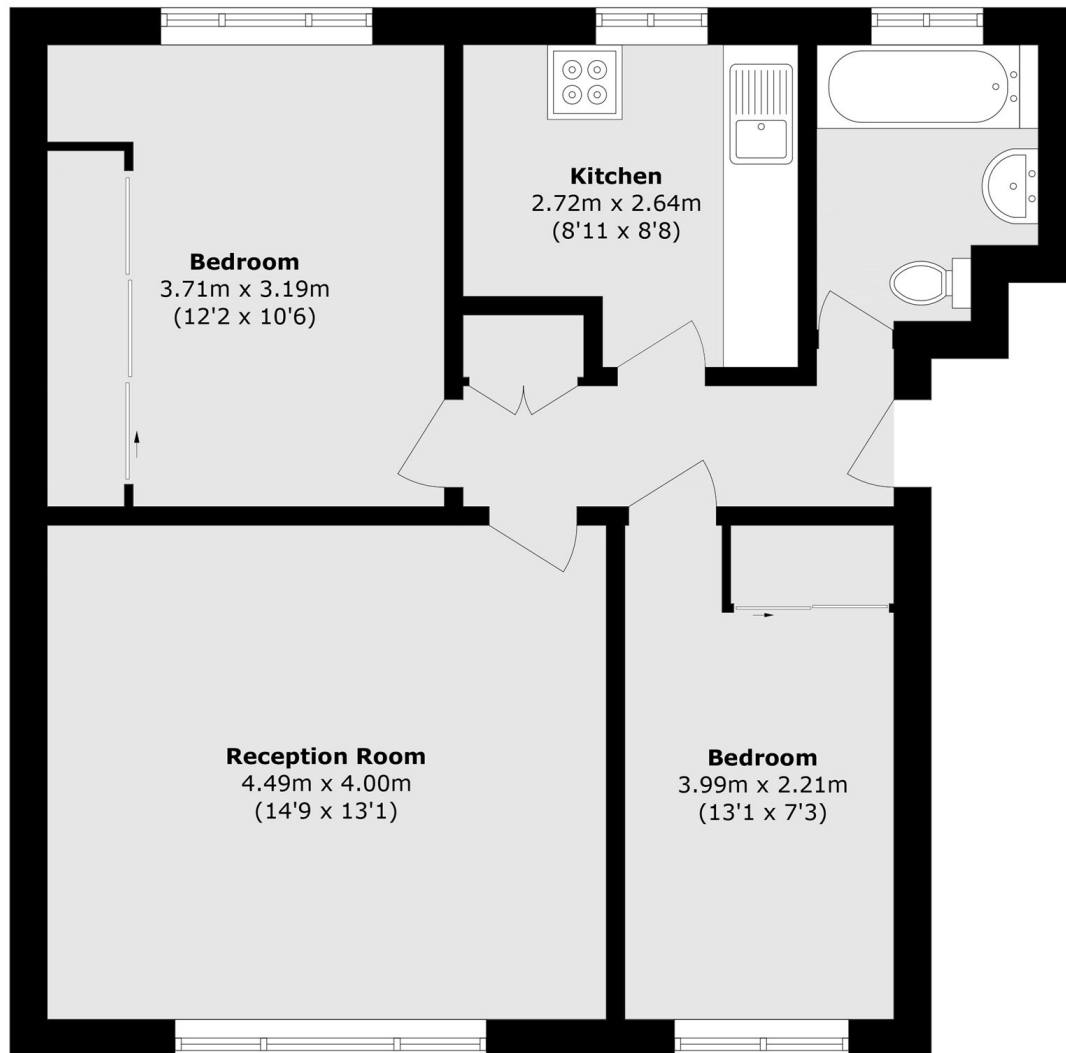

Total area (approx.): 55.4 sq. m (596.3 sq. ft)