



## Chaucer Drive, SE1

**£369** Per week

One bedroom flat within a secure purpose built block which has been refurbished to a high standard. The perfect property for a single professional or couple,

Chaucer Drive is enviably located, with numerous local amenities nearby, plus excellent bus routes. Bermondsey Underground, South Bermondsey Station and Elephant & Castle are all within easy reach.

### Features

- Raised Ground Floor
- Double Bedroom
- Open Plan Living
- Permit Parking
- Secure Block
- Great Transport Links

# Chaucer Drive, London, SE1

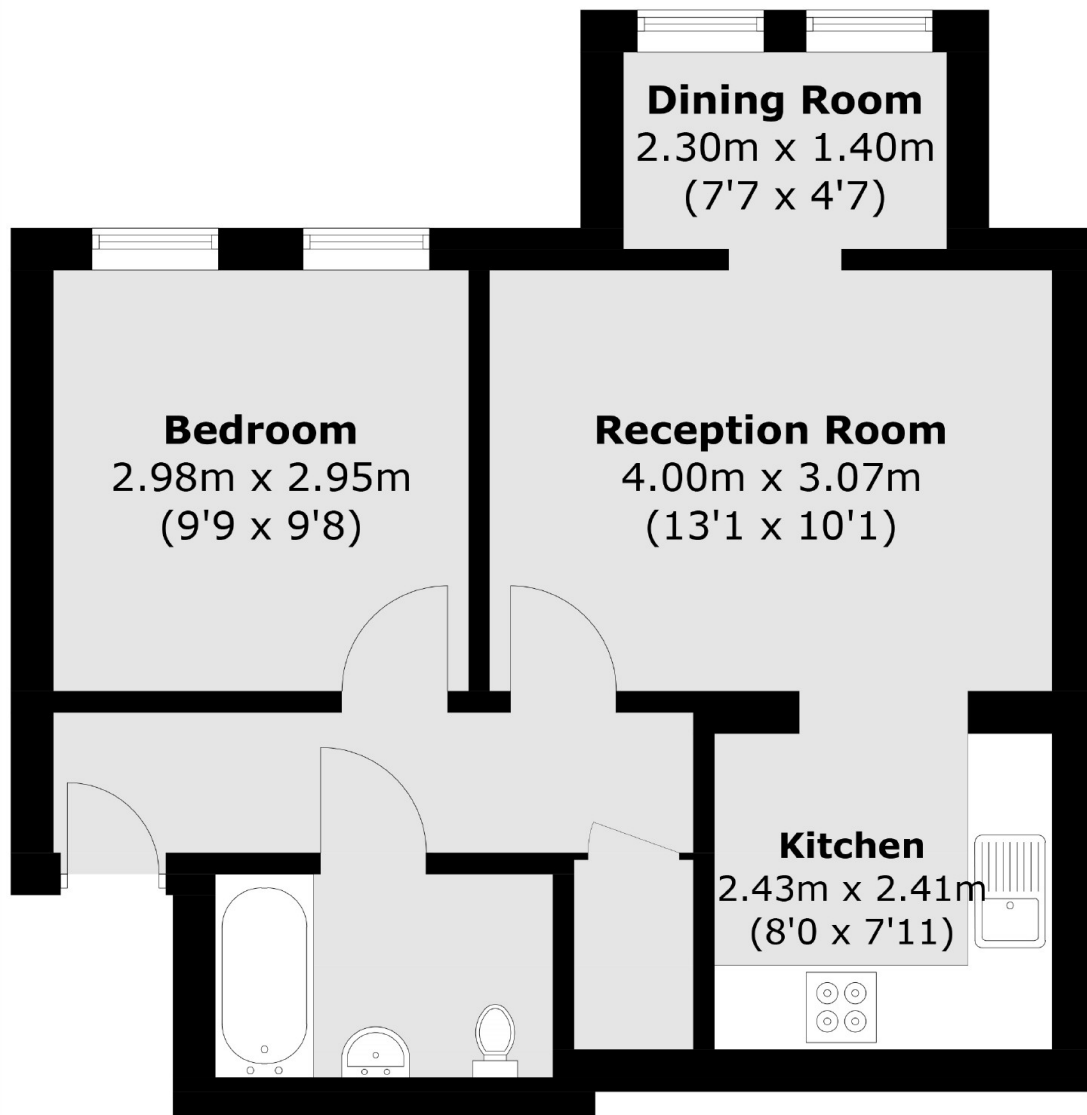

## Ground Floor

Total area (approx.): 41.9 sq. m (451.0 sq. ft)